

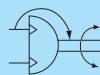

DOUBLE ACTING
- SINGLE END ROD TYPE **MRH**



Features

- Compact body.
- Functional design with clean appearance.
- Simple mounting of sensors.
- Magnetic as standard.

Specification

Type	MRH
Bore	Φ63
Power fluid	Filtered air with or without lubrication
The range of pressure	1 ~ 9.9 kgf/cm ²
Proof pressure	15 kgf/cm ²
The range of temperature	-5 ~ +60 °C (Don't freeze)
Acting accuracy	0 ~ +4°
Material of cylinder barrel	Aluminium extrusion, Anodised 20 microns

How to order

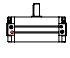
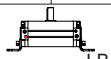
MRH	SD	63	-	90	-	A	1
Type	Holder	Bore		Rotaty angle		Sensor switch	Quantity
 MRH	 SD  LB	63 : Φ63		90 : 90° 180 : 180°		ZE101	1 : 1pc 2 : 2pcs

Load of the spigot shaft table

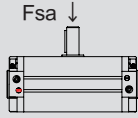
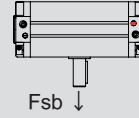
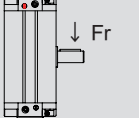
Load direction			
	Fsa	Fsb	Fr
Φ63	60	20	30

Output torque table

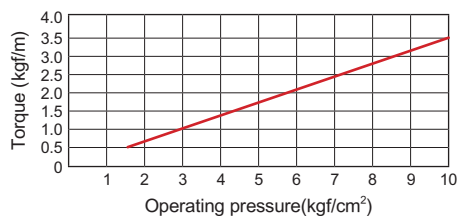

Cylinder weight

Bore	Φ63		
Type	90°	180°	LB
Weight	2.7	3.1	0.4

MRH Double acting type / Inside structure

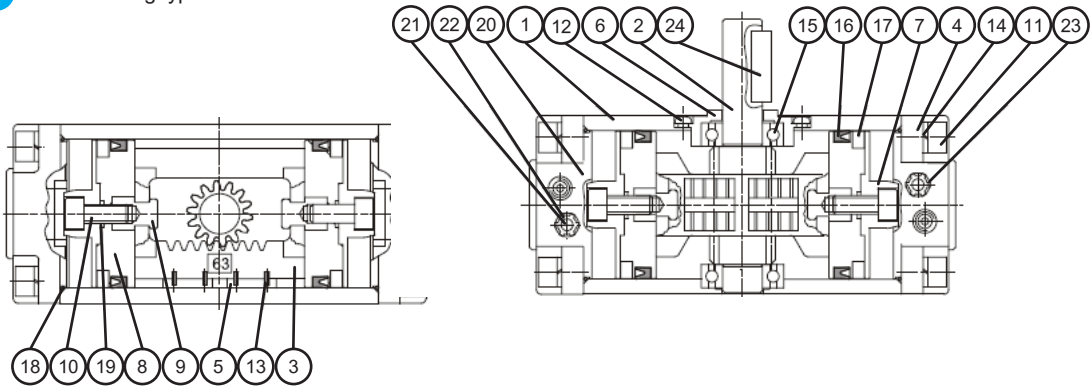

Parts List

No.	Part name	Material	No.	Part name	Material	No.	Part name	Material
1	Body	Aluminium alloy	9	Screw#1	Carbon steel	17	Magnet ring	Magner material
2	Shaft	Medium carbon steel	10	Screw#2	SCM	18	Gasket	NBR
3	Rack	Carbon steel	11	Blot	SCM	19	O ring	NBR
4	Cover	Aluminium alloy	12	Screw	SCM	20	Cushion packing	NBR
5	Slide	plastic	13	Spring pin	Spring steel	21	Cushion valve	Copper
6	Bearing retainer	Aluminium alloy	14	Spring Washer	SCM	22	Needle valve gasket	NBR
7	Piston #1	Aluminium alloy	15	Bearing	Bearing steel	23	Needle washer	Aluminium alloy
8	Piston #2	Aluminium alloy	16	Piston packing	NBR	24	Parallel key	Carbon steel

MRH Double acting type / Dimensional features

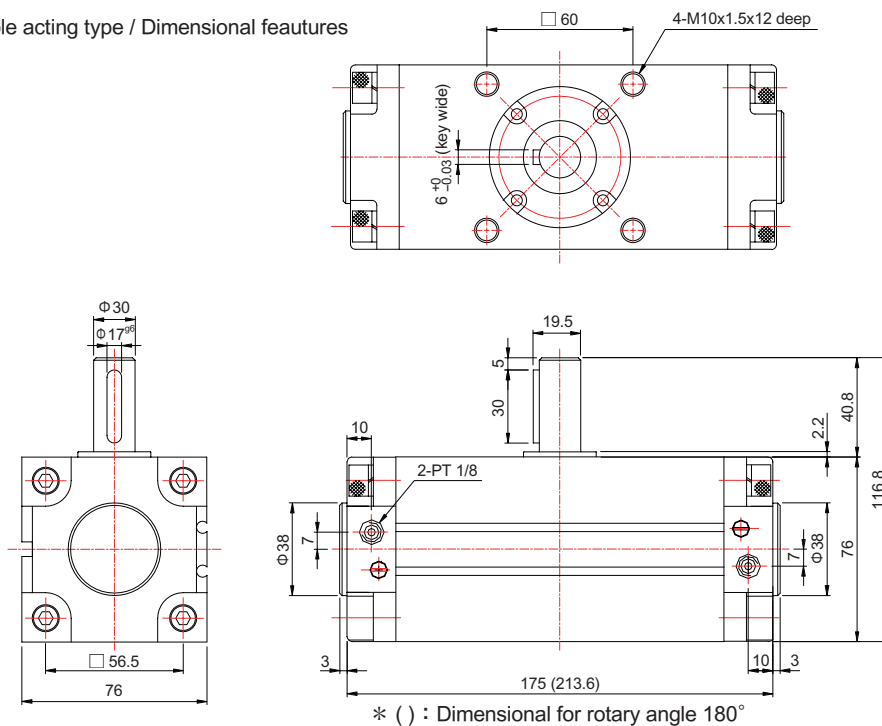

MRH Double acting type / Accessories
