

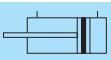

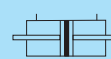

| | | |
|---|----------------|---|
| DOUBLE ACTING - SINGLE END ROD TYPE | 10Z-6 |  |
| DOUBLE ACTING - DOUBLE END ROD TYPE | 10Z-6D |  |
| SINGLE ACTING - NORMALLY RETRACTED PISTON ROD TYPE | 10Z-6SR |  |
| SINGLE ACTING - NORMALLY EXTENDED PISTON ROD TYPE | 10Z-6SH |  |

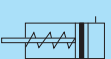







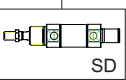
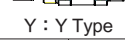

Features

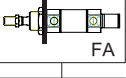
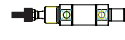
- Piston with magnet is standard accessory in the series cylinders.
- End cushion is optional accessory except bore size $\phi 12$, $\phi 16$ mm.

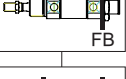
Specification

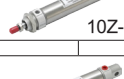
| Type | 10Z-6 | 10Z-6A | 10Z-6D | 10Z-6SR | 10Z-6ASR | 10Z-6SH | 10Z-6ASH |
|-----------------------------|--|--------|--------|---|----------|---------|----------|
| Bore | Φ 12、16、20、25、32、40 | | | | | | |
| Power fluid | Filtered air with or without lubrication | | | | | | |
| The range of pressure | Double acting : 10 kgf/cm2 | | | Single acting : 2.5 ~ 10kgf/cm ² | | | |
| The range of temperature | -10 ~ +60 °C (Don't freeze) | | | | | | |
| Material of cylinder barrel | Stainless steel | | | | | | |

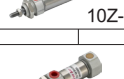
How to order

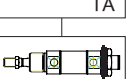
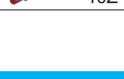
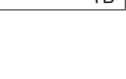
| 10Z-6 | SD | 25 | N | 125 | - | Y | - | A | 1 |
|--|---|--|--|-------------------------------|---|---|---|---------------|-----------------------|
| Type | Holder | Bore | Cushion | Stroke | | Accessories | | Sensor switch | Quantity |
|  10Z-6 |  SD | 12 : $\Phi 12$ 16 : $\Phi 16$ 20 : $\Phi 20$ | B : Both end with cushion N : No cushion | Please see stroke table | |  Y : Y Type | | DI106 | 1 : 1 pc 2 : 2 pcs |
|  10Z-6A |  FA | 25 : $\Phi 25$ 32 : $\Phi 32$ 40 : $\Phi 40$ | | | |  I : I Type | | | |
|  10Z-6D |  FB | | | | |  S : Oscillating eye | | | |
|  10Z-6SR |  LB | | | | |  F : Compensating joint | | | |
|  10Z-6ASR |  CU | | | | | | | | |
|  10Z-6SH |  TA | | | | | | | | |
|  10Z-6ASH |  TB | | | | | | | | |

Stroke table

| Bore | Stroke (mm) |
|---|--------------------------------------|
| $\Phi 12$ 、 $\Phi 16$ 、 $\Phi 20$ 、 $\Phi 25$ 、 $\Phi 32$ 、 $\Phi 40$ | 25,50,75,100,125,150,175,200,250,300 |

10Z-6 Double acting - single end rod type / Dimensional features

● Bore $\Phi 12 \sim \Phi 16$

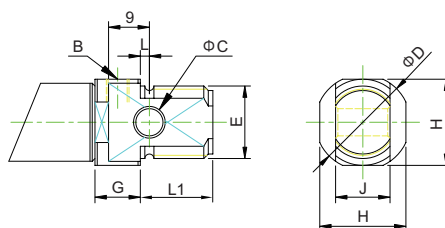

● Bore $\Phi 20 \sim \Phi 40$

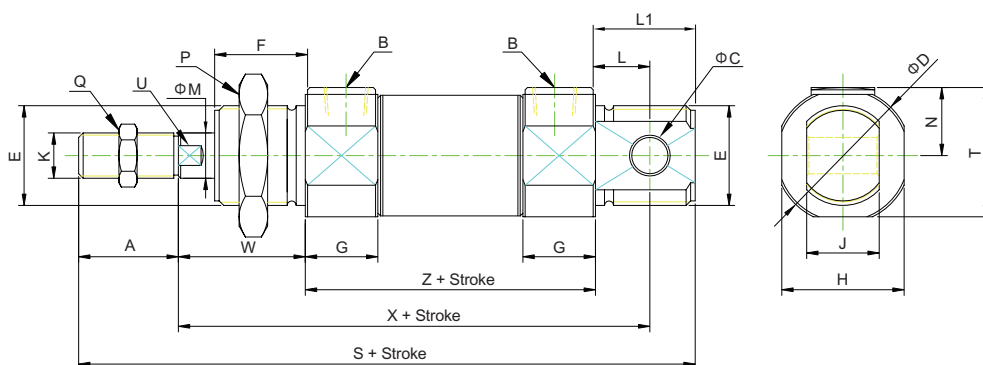

10Z-6A Double acting - single end rod type / Dimensional features

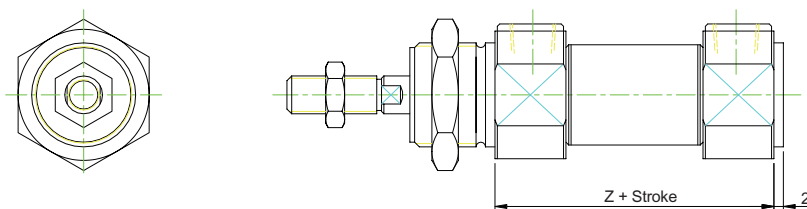

Dimensional Table

| Mark Bore | A | B | C | D | E | F | G | H | J | K | L | L1 | M | N | P | Q | S | T | U | W | X | Z |
|--------------|----|--------|----|----|---------|----|----|----|----|----------|----|----|----|------|----|----|-----|------|----|----|-----|----|
| Φ 12 | 16 | M5x0.8 | 6 | 21 | M16x1.5 | 16 | 10 | 19 | 12 | M6x1.0 | 2 | 16 | 6 | — | 24 | 12 | 105 | — | 5 | 22 | 75 | 51 |
| Φ 16 | 16 | M5x0.8 | 6 | 21 | M16x1.5 | 16 | 10 | 19 | 12 | M6x1.0 | 2 | 16 | 6 | — | 24 | 12 | 112 | — | 5 | 22 | 82 | 58 |
| Φ 20 | 20 | PT 1/8 | 8 | 30 | M22x1.5 | 18 | 15 | 27 | 16 | M8x1.25 | 12 | 22 | 8 | 15 | 27 | 14 | 125 | 28.5 | 7 | 24 | 95 | 59 |
| Φ 25 | 22 | PT 1/8 | 8 | 30 | M22x1.5 | 20 | 16 | 27 | 16 | M10x1.25 | 12 | 22 | 10 | 15 | 27 | 17 | 136 | 28.5 | 9 | 28 | 104 | 64 |
| Φ 32 | 23 | PT 1/8 | 10 | 38 | M27x2.0 | 20 | 16 | 35 | 20 | M10x1.25 | 15 | 27 | 12 | 19 | 35 | 17 | 150 | 36.5 | 10 | 28 | 115 | 72 |
| Φ 40 | 23 | PT 1/8 | 10 | 45 | M33x2.0 | 20 | 16 | 42 | 20 | M14x1.5 | 15 | 27 | 16 | 22.5 | 41 | 22 | 150 | 43.5 | 14 | 28 | 115 | 72 |

10Z-6D Double acting - double end rod type/ Mounting dimension

● Bore $\Phi 12 \sim \Phi 16$

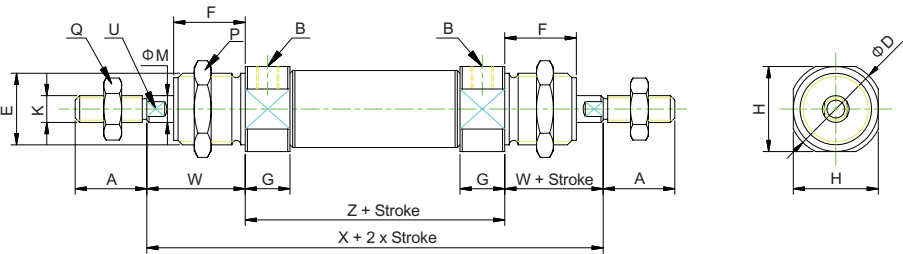

● Bore $\Phi 20 \sim \Phi 40$

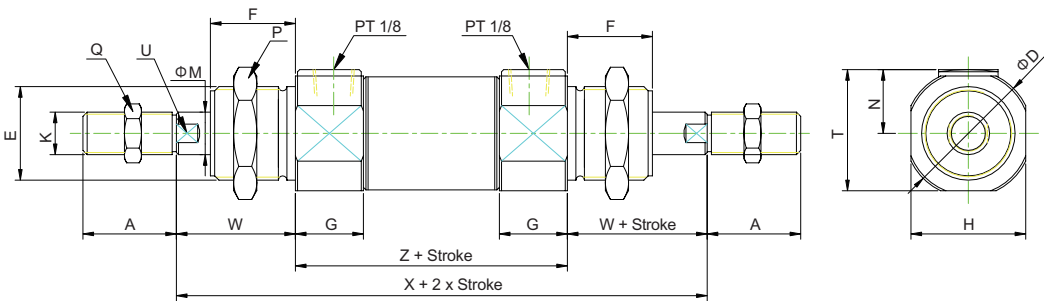

Dimensional Table

| Mark Bore | A | B | D | E | F | G | H | K | M | N | P | Q | S | T | U | W | X | Z |
|--------------|----|--------|----|---------|----|----|----|----------|----|------|----|----|-----|------|----|----|-----|----|
| Φ 12 | 16 | M5x0.8 | 21 | M16x1.5 | 16 | 10 | 19 | M6x1.0 | 6 | — | 24 | 12 | 105 | — | 5 | 22 | 95 | 51 |
| Φ 16 | 16 | M5x0.8 | 21 | M16x1.5 | 16 | 10 | 19 | M6x1.0 | 6 | — | 24 | 12 | 112 | — | 5 | 22 | 102 | 58 |
| Φ 20 | 20 | PT 1/8 | 30 | M22x1.5 | 18 | 15 | 27 | M8x1.25 | 8 | 15 | 27 | 14 | 125 | 28.5 | 7 | 24 | 107 | 59 |
| Φ 25 | 22 | PT 1/8 | 30 | M22x1.5 | 20 | 16 | 27 | M10x1.25 | 10 | 15 | 27 | 17 | 136 | 28.5 | 9 | 28 | 120 | 64 |
| Φ 32 | 23 | PT 1/8 | 38 | M27x2.0 | 20 | 16 | 35 | M10x1.25 | 12 | 19 | 35 | 17 | 150 | 36.5 | 10 | 28 | 128 | 72 |
| Φ 40 | 23 | PT 1/8 | 45 | M33x2.0 | 20 | 16 | 42 | M14x1.5 | 16 | 22.5 | 41 | 22 | 150 | 43.5 | 14 | 28 | 128 | 72 |

FA (FB) Double acting / Mounting dimension

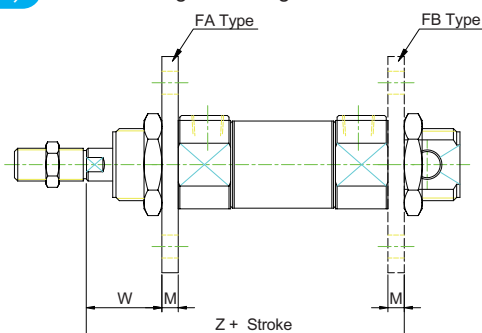

● Bore Φ12 ~ Φ25

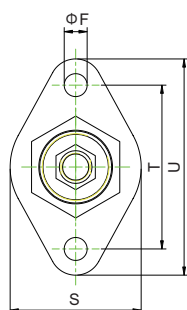

● Bore Φ32 ~ Φ40

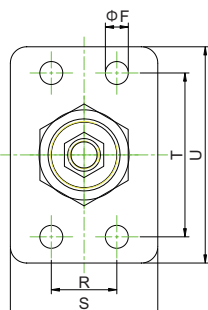

Dimensional Table FA (FB) Type

| Mark Bore | F | M | R | S | T | U |
|-----------|------|-------|----|----|----|-----|
| Φ12 | 6 | 4 | - | 30 | 40 | 53 |
| Φ16 | 6 | 4 | - | 30 | 40 | 53 |
| Φ20 | 7 | 5 | - | 40 | 50 | 66 |
| Φ25 | 7 | 5 | - | 40 | 50 | 66 |
| Φ32 | 7 | 5 | 20 | 45 | 60 | 80 |
| Φ40 | 9 | 5 | 30 | 50 | 80 | 100 |
| Mark Bore | W | Z | | | | |
| Φ12 | 18 | 77 | | | | |
| Φ16 | 18 | 84 | | | | |
| Φ20 | 19 | 88 | | | | |
| Φ25 | 23 | 97 | | | | |
| Φ32 | 23.5 | 104.5 | | | | |
| Φ40 | 23.5 | 104.5 | | | | |

Dimensional Table LB Type

| Mark Bore | A | B | C | F | N | R |
|-----------|------|----|----|----|-----|----|
| Φ12 | 4 | 14 | 20 | 6 | 20 | 8 |
| Φ16 | 4 | 14 | 20 | 6 | 20 | 8 |
| Φ20 | 5 | 17 | 25 | 7 | 25 | 7 |
| Φ25 | 5 | 17 | 25 | 7 | 25 | 11 |
| Φ32 | 5 | 20 | 30 | 7 | 35 | 8 |
| Φ40 | 5 | 20 | 30 | 9 | 40 | 8 |
| Mark Bore | S | T | U | X | Z | |
| Φ12 | 32 | 32 | 42 | 31 | 79 | |
| Φ16 | 32 | 32 | 42 | 38 | 86 | |
| Φ20 | 36 | 40 | 54 | 35 | 93 | |
| Φ25 | 40 | 40 | 54 | 40 | 98 | |
| Φ32 | 43.5 | 40 | 55 | 42 | 112 | |
| Φ40 | 43.5 | 50 | 75 | 42 | 112 | |

LB Double acting / Mounting dimensional

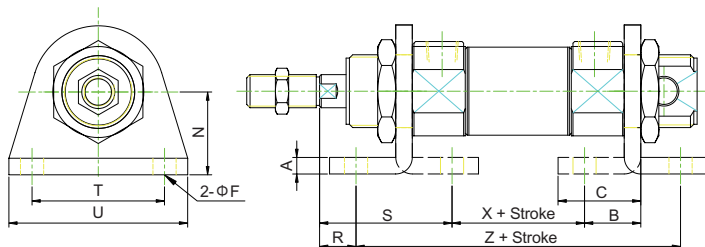

Dimensional Table CU Type

| Mark Bore | A | B | C | D | F | H |
|-----------|-----|----|----|-----|---|----|
| Φ12 | 12 | 18 | 15 | 25 | 6 | 27 |
| Φ16 | 12 | 18 | 15 | 25 | 6 | 27 |
| Φ20 | 16 | 24 | 20 | 32 | 7 | 30 |
| Φ25 | 16 | 24 | 20 | 32 | 7 | 30 |
| Φ32 | 20 | 28 | 25 | 40 | 7 | 40 |
| Φ40 | 20 | 28 | 25 | 40 | 9 | 40 |
| Mark Bore | L | M | T | Z | | |
| Φ12 | 5 | 13 | 3 | 73 | | |
| Φ16 | 5 | 13 | 3 | 80 | | |
| Φ20 | 6 | 16 | 4 | 91 | | |
| Φ25 | 6 | 16 | 4 | 100 | | |
| Φ32 | 7.5 | 20 | 4 | 110 | | |
| Φ40 | 7.5 | 20 | 4 | 110 | | |

CU Double acting / Mounting Dimension

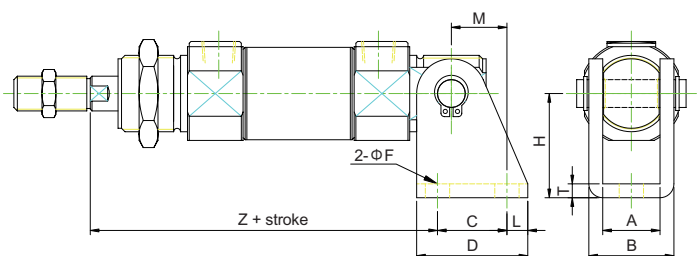

10Z-6SR Single acting - normally retracted piston rod type / Mounting dimension

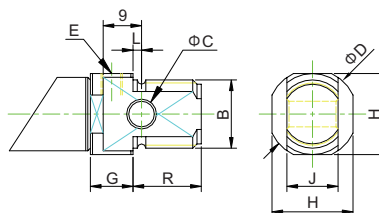
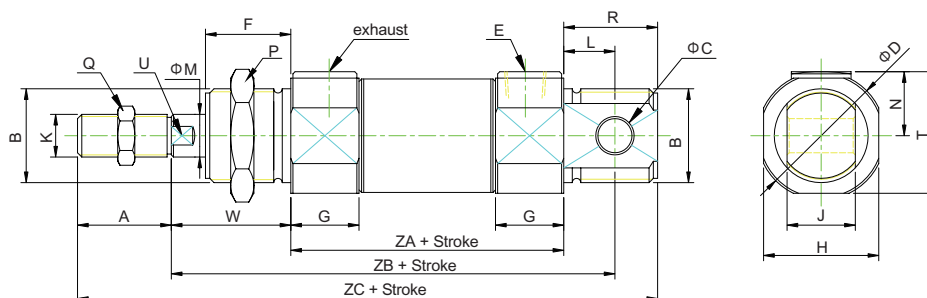
 ● Bore $\Phi 16$

 ● Bore $\Phi 20 \sim \Phi 40$

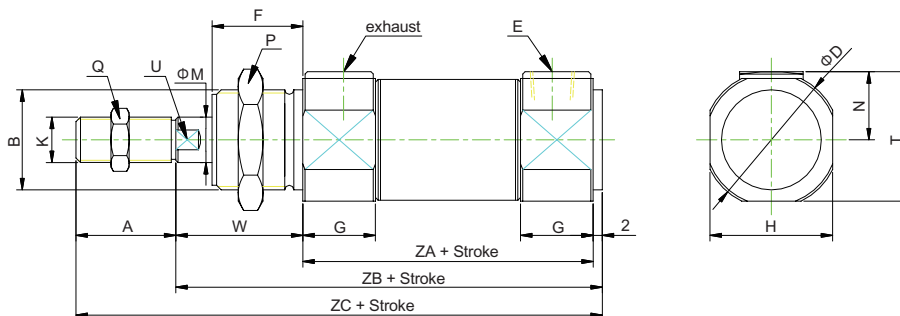
Dimensional Table

| Mark Bore | A | B | C | D | E | F | G | H | J | K | L | M | N | P | Q | R | T | U | W | Stroke 1~50 | | | Stroke 51~100 | | |
|--------------|----|---------|----|----|--------|----|----|----|----|----------|----|----|------|----|----|----|------|----|----|-------------|-----|-----|---------------|-----|-----|
| | | | | | | | | | | | | | | | | | | | | ZA | ZB | ZC | ZA | ZB | ZC |
| Φ 16 | 16 | M16x1.5 | 6 | 21 | M5x0.8 | 16 | 10 | 19 | 12 | M6x1.0 | 2 | 6 | — | 24 | 12 | 16 | — | 5 | 22 | 58 | 82 | 112 | 83 | 107 | 137 |
| Φ 20 | 20 | M22x1.5 | 8 | 30 | PT 1/8 | 18 | 15 | 27 | 16 | M8x1.25 | 12 | 8 | 15 | 27 | 14 | 22 | 28.5 | 7 | 24 | 59 | 95 | 125 | 84 | 120 | 150 |
| Φ 25 | 22 | M22x1.5 | 8 | 30 | PT 1/8 | 20 | 16 | 27 | 16 | M10x1.25 | 12 | 10 | 15 | 27 | 17 | 22 | 28.5 | 9 | 28 | 64 | 104 | 136 | 89 | 129 | 161 |
| Φ 32 | 23 | M27x2.0 | 10 | 38 | PT 1/8 | 20 | 16 | 35 | 20 | M10x1.25 | 15 | 12 | 19 | 35 | 17 | 27 | 36.5 | 10 | 28 | 72 | 115 | 150 | 97 | 140 | 175 |
| Φ 40 | 23 | M33x2.0 | 10 | 45 | PT 1/8 | 20 | 16 | 42 | 20 | M14x1.5 | 15 | 16 | 22.5 | 41 | 22 | 27 | 43.5 | 14 | 28 | 72 | 115 | 150 | 97 | 140 | 175 |

10Z-6ASR Single acting - normally retracted piston rod type / Mounting dimension

Dimensional Table

| Mark Bore | A | B | D | E | F | G | H | K | M | N | P | Q | T | U | W | Stroke 1~50 | | | Stroke 51~100 | | |
|--------------|----|---------|----|--------|----|----|----|----------|----|------|----|----|------|----|----|-------------|-----|-----|---------------|-----|-----|
| | | | | | | | | | | | | | | | | ZA | ZB | ZC | ZA | ZB | ZC |
| Φ 16 | 16 | M16x1.5 | 21 | M5x0.8 | 16 | 10 | 19 | M6x1.0 | 6 | — | 24 | 12 | — | 5 | 22 | 58 | 80 | 96 | 83 | 105 | 121 |
| Φ 20 | 20 | M22x1.5 | 30 | PT 1/8 | 18 | 15 | 27 | M8x1.25 | 8 | 15 | 27 | 14 | 28.5 | 7 | 24 | 59 | 83 | 103 | 84 | 108 | 128 |
| Φ 25 | 22 | M22x1.5 | 30 | PT 1/8 | 20 | 16 | 27 | M10x1.25 | 10 | 15 | 27 | 17 | 28.5 | 9 | 28 | 64 | 92 | 114 | 89 | 117 | 139 |
| Φ 32 | 23 | M27x2.0 | 38 | PT 1/8 | 20 | 16 | 35 | M10x1.25 | 12 | 19 | 35 | 17 | 36.5 | 10 | 28 | 72 | 100 | 123 | 97 | 125 | 148 |
| Φ 40 | 23 | M33x2.0 | 45 | PT 1/8 | 20 | 16 | 42 | M14x1.5 | 16 | 22.5 | 41 | 22 | 43.5 | 14 | 28 | 72 | 100 | 123 | 97 | 125 | 148 |

FA (FB)

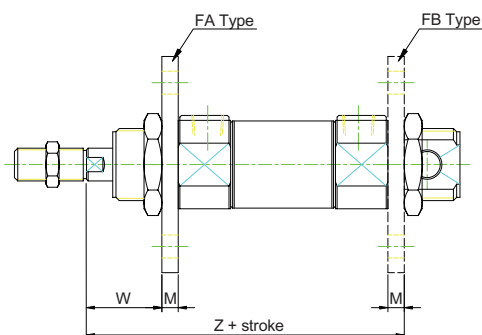
Single acting - normally retracted piston rod type / Mounting dimensional



● Bore Φ16 ~ Φ25

● Bore Φ32 ~ Φ40

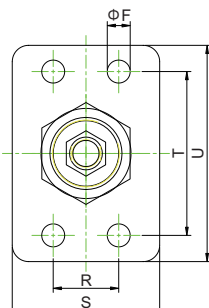
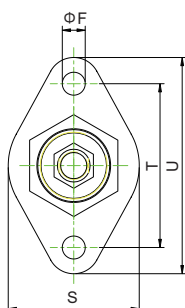

Dimensional Table

FA (FB) Type

| Mark Bore | F | M | R | S | T | U |
|-----------|---|---|----|----|----|-----|
| Φ16 | 6 | 4 | - | 30 | 40 | 53 |
| Φ20 | 7 | 5 | - | 40 | 50 | 66 |
| Φ25 | 7 | 5 | - | 40 | 50 | 66 |
| Φ32 | 7 | 5 | 20 | 45 | 60 | 80 |
| Φ40 | 9 | 5 | 30 | 50 | 80 | 100 |

| Mark Bore | W | Z | |
|-----------|------|-------------|---------------|
| | | Stroke 1~50 | Stroke 51~100 |
| Φ12 | 18 | 84 | 109 |
| Φ20 | 19 | 88 | 113 |
| Φ25 | 23 | 97 | 122 |
| Φ32 | 23.5 | 104.5 | 129.5 |
| Φ40 | 23.5 | 104.5 | 129.5 |

Dimensional Table

LB Type

| Mark Bore | A | B | C | F | N | R |
|-----------|---|----|----|---|----|----|
| Φ16 | 4 | 14 | 20 | 6 | 20 | 8 |
| Φ20 | 5 | 17 | 25 | 7 | 25 | 7 |
| Φ25 | 5 | 17 | 25 | 7 | 25 | 11 |
| Φ32 | 5 | 20 | 30 | 7 | 35 | 8 |
| Φ40 | 5 | 20 | 30 | 9 | 40 | 8 |

| Mark Bore | S | T | U | X | | Z | |
|-----------|------|----|----|-------------|---------------|-------------|---------------|
| | | | | Stroke 1~50 | Stroke 51~100 | Stroke 1~50 | Stroke 51~100 |
| Φ16 | 32 | 32 | 42 | 38 | 86 | 63 | 111 |
| Φ20 | 36 | 40 | 54 | 35 | 93 | 60 | 118 |
| Φ25 | 40 | 40 | 54 | 40 | 98 | 65 | 123 |
| Φ32 | 43.5 | 40 | 55 | 42 | 112 | 66 | 137 |
| Φ40 | 43.5 | 50 | 75 | 42 | 112 | 66 | 137 |

LB

Single acting - normally retracted piston rod type / Mounting dimensional

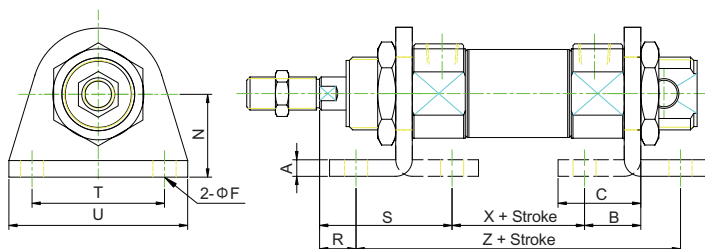

CU

Single acting - normally retracted piston rod type / Mounting dimensional

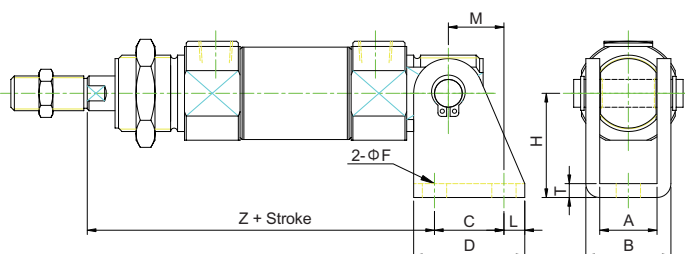

Dimensional Table

CU Type

| Mark Bore | A | B | C | D | F | H |
|-----------|----|----|----|----|---|----|
| Φ16 | 12 | 18 | 15 | 25 | 6 | 27 |
| Φ20 | 16 | 24 | 20 | 32 | 7 | 30 |
| Φ25 | 16 | 24 | 20 | 32 | 7 | 30 |
| Φ32 | 20 | 28 | 25 | 40 | 7 | 40 |
| Φ40 | 20 | 28 | 25 | 40 | 9 | 40 |

| Mark Bore | L | M | T | Z | |
|-----------|-----|----|---|-------------|---------------|
| | | | | Stroke 1~50 | Stroke 51~100 |
| Φ16 | 5 | 13 | 3 | 80 | 105 |
| Φ20 | 6 | 16 | 4 | 91 | 116 |
| Φ25 | 6 | 16 | 4 | 100 | 125 |
| Φ32 | 7.5 | 20 | 4 | 110 | 135 |
| Φ40 | 7.5 | 20 | 4 | 110 | 135 |

10Z-6SH Single acting - normally extended piston rod type / Dimensional features

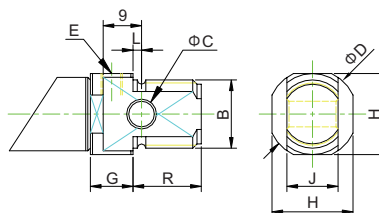
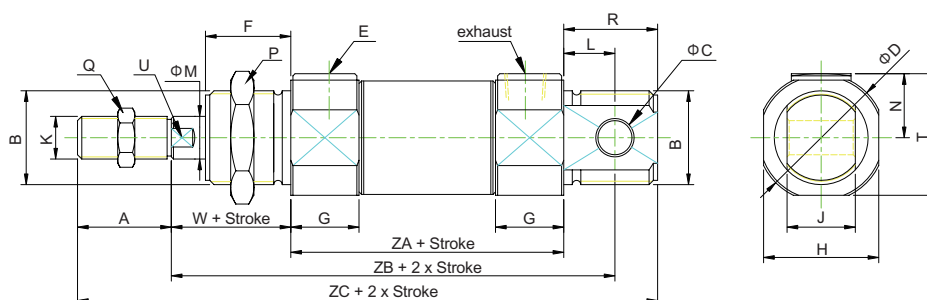
 ● Bore $\Phi 16$

 ● Bore $\Phi 20 \sim \Phi 40$

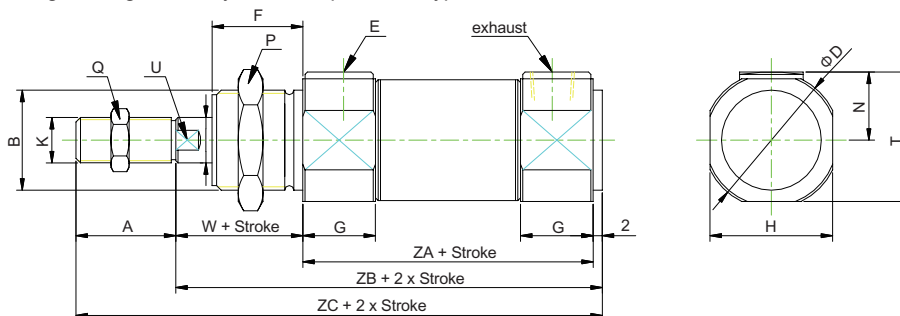
Dimensional Table

| Mark Bore | A | B | C | D | E | F | G | H | J | K | L | M | N | P | Q | R | T | U | W | Stroke 1~50 | | | Stroke 51~100 | | |
|--------------|----|---------|----|----|--------|----|----|----|----|----------|----|----|------|----|----|----|------|----|----|-------------|-----|-----|---------------|-----|-----|
| | | | | | | | | | | | | | | | | | | | | ZA | ZB | ZC | ZA | ZB | ZC |
| Φ 16 | 16 | M16x1.5 | 6 | 21 | M5x0.8 | 16 | 10 | 19 | 12 | M6x1.0 | 2 | 6 | — | 24 | 12 | 16 | — | 5 | 22 | 58 | 82 | 112 | 83 | 107 | 137 |
| Φ 20 | 20 | M22x1.5 | 8 | 30 | PT 1/8 | 18 | 15 | 27 | 16 | M8x1.25 | 12 | 8 | 15 | 27 | 14 | 22 | 28.5 | 7 | 24 | 59 | 95 | 125 | 84 | 120 | 150 |
| Φ 25 | 22 | M22x1.5 | 8 | 30 | PT 1/8 | 20 | 16 | 27 | 16 | M10x1.25 | 12 | 10 | 15 | 27 | 17 | 22 | 28.5 | 9 | 28 | 64 | 104 | 136 | 89 | 129 | 161 |
| Φ 32 | 23 | M27x2.0 | 10 | 38 | PT 1/8 | 20 | 16 | 35 | 20 | M10x1.25 | 15 | 12 | 19 | 35 | 17 | 27 | 36.5 | 10 | 28 | 72 | 115 | 150 | 97 | 140 | 175 |
| Φ 40 | 23 | M33x2.0 | 10 | 45 | PT 1/8 | 20 | 16 | 42 | 20 | M14x1.5 | 15 | 16 | 22.5 | 41 | 22 | 27 | 43.5 | 14 | 28 | 72 | 115 | 150 | 97 | 140 | 175 |

10Z-6ASH Single acting - normally extended piston rod type / Dimensional features

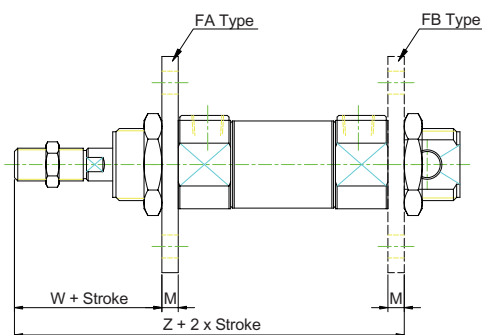
Dimensional Table

| Mark Bore | A | B | D | E | F | G | H | K | M | N | P | Q | T | U | W | Stroke 1~50 | | | Stroke 51~100 | | |
|--------------|----|---------|----|--------|----|----|----|----------|----|------|----|----|------|----|----|-------------|-----|-----|---------------|-----|-----|
| | | | | | | | | | | | | | | | | ZA | ZB | ZC | ZA | ZB | ZC |
| Φ 16 | 16 | M16x1.5 | 21 | M5x0.8 | 16 | 10 | 19 | M6x1.0 | 6 | — | 24 | 12 | — | 5 | 22 | 58 | 80 | 96 | 83 | 105 | 121 |
| Φ 20 | 20 | M22x1.5 | 30 | PT 1/8 | 18 | 15 | 27 | M8x1.25 | 8 | 15 | 27 | 14 | 28.5 | 7 | 24 | 59 | 83 | 103 | 84 | 108 | 128 |
| Φ 25 | 22 | M22x1.5 | 30 | PT 1/8 | 20 | 16 | 27 | M10x1.25 | 10 | 15 | 27 | 17 | 28.5 | 9 | 28 | 64 | 92 | 114 | 89 | 117 | 139 |
| Φ 32 | 23 | M27x2.0 | 38 | PT 1/8 | 20 | 16 | 35 | M10x1.25 | 12 | 19 | 35 | 17 | 36.5 | 10 | 28 | 72 | 100 | 123 | 97 | 125 | 148 |
| Φ 40 | 23 | M33x2.0 | 45 | PT 1/8 | 20 | 16 | 42 | M14x1.5 | 16 | 22.5 | 41 | 22 | 43.5 | 14 | 28 | 72 | 100 | 123 | 97 | 125 | 148 |

FA (FB) Single acting - normally extended piston rod type / Mounting dimension



● Bore Φ16 ~ Φ25

● Bore Φ32 ~ Φ40

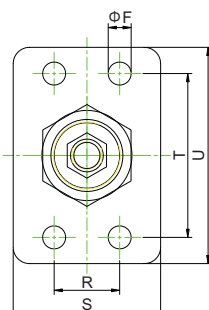
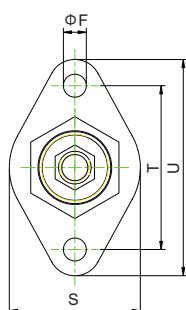

Dimensional Table FA (FB) Type

| Mark Bore | F | M | R | S | T | U |
|-----------|------|-------------|----|---------------|----|-----|
| Φ16 | 6 | 4 | - | 30 | 40 | 53 |
| Φ20 | 7 | 5 | - | 40 | 50 | 66 |
| Φ25 | 7 | 5 | - | 40 | 50 | 66 |
| Φ32 | 7 | 5 | 20 | 45 | 60 | 80 |
| Φ40 | 9 | 5 | 30 | 50 | 80 | 100 |
| Mark Bore | W | Z | | | | |
| | | Stroke 1~50 | | Stroke 51~100 | | |
| Φ16 | 18 | 84 | | 109 | | |
| Φ20 | 19 | 88 | | 113 | | |
| Φ25 | 23 | 97 | | 122 | | |
| Φ32 | 23.5 | 104.5 | | 129.5 | | |
| Φ40 | 23.5 | 104.5 | | 129.5 | | |

Dimensional Table LB Type

| Mark Bore | A | B | C | F | N | R | |
|--------------|------|----|----|-------------|-----|---------------|-----|
| Φ16 | 4 | 14 | 20 | 6 | 20 | 8 | |
| Φ20 | 5 | 17 | 25 | 7 | 25 | 7 | |
| Φ25 | 5 | 17 | 25 | 7 | 25 | 11 | |
| Φ32 | 5 | 20 | 30 | 7 | 35 | 8 | |
| Φ40 | 5 | 20 | 30 | 9 | 40 | 8 | |
| Mark Bore | S | T | U | X | Z | X | Z |
| | | | | Stroke 1~50 | | Stroke 51~100 | |
| Φ16 | 32 | 32 | 42 | 38 | 86 | 63 | 111 |
| Φ20 | 36 | 40 | 54 | 35 | 93 | 60 | 118 |
| Φ25 | 40 | 40 | 54 | 40 | 98 | 65 | 123 |
| Φ32 | 43.5 | 40 | 55 | 41 | 112 | 66 | 137 |
| Φ40 | 43.5 | 50 | 75 | 41 | 112 | 66 | 137 |

LB Single acting - normally extended piston rod type / Mounting dimension

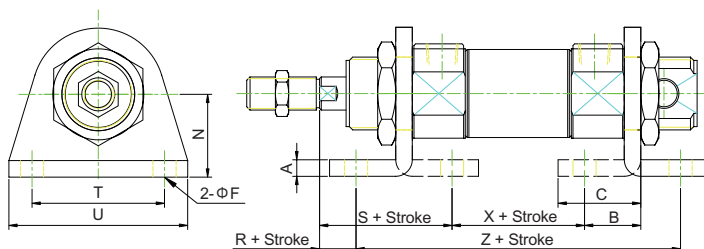

Dimensional Table CU Type

| Mark Bore | A | B | C | D | F | H |
|-----------|-----|----|----|-------------|---|---------------|
| Φ16 | 12 | 18 | 15 | 25 | 6 | 27 |
| Φ20 | 16 | 24 | 20 | 32 | 7 | 30 |
| Φ25 | 16 | 24 | 20 | 32 | 7 | 30 |
| Φ32 | 20 | 28 | 25 | 40 | 7 | 40 |
| Φ40 | 20 | 28 | 25 | 40 | 9 | 40 |
| Mark Bore | L | M | T | Z | | |
| | | | | Stroke 1~50 | | Stroke 51~100 |
| Φ16 | 5 | 13 | 3 | 80 | | 105 |
| Φ20 | 6 | 16 | 4 | 91 | | 116 |
| Φ25 | 6 | 16 | 4 | 100 | | 125 |
| Φ32 | 7.5 | 20 | 4 | 110 | | 135 |
| Φ40 | 7.5 | 20 | 4 | 110 | | 135 |

CU Single acting - normally extended piston rod type / Mounting dimension

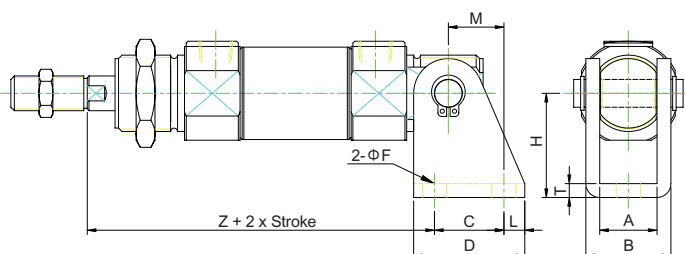

10Z-6

Sensor switches / Dimensional features

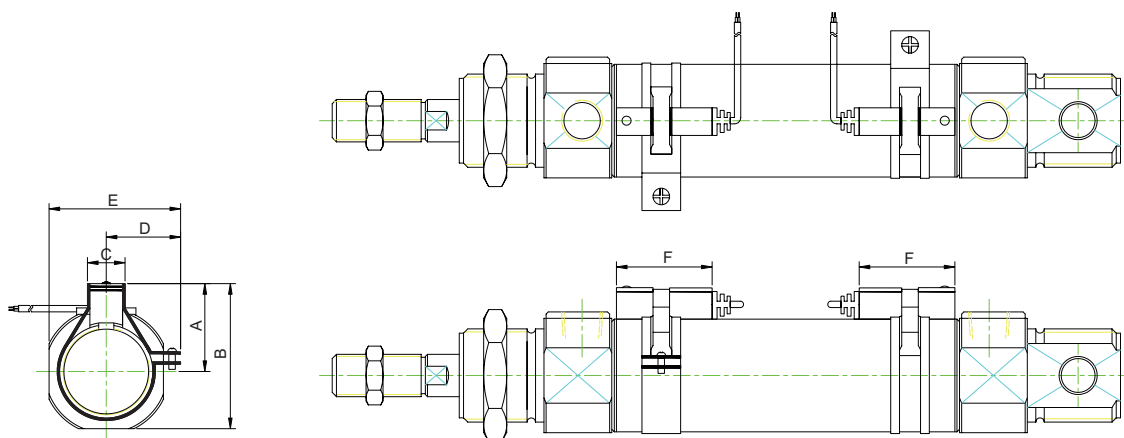

Dimensional Table

| Mark Bore | Sensor switch | A | B | C | D | E | F |
|--------------|---------------|------|----|---|------|----|----|
| Φ 16 | DI106 | 18.5 | 28 | 8 | 17.5 | 27 | 25 |
| Φ 20 | DI106 | 22.5 | 36 | 8 | 21.5 | 35 | 25 |
| Φ 25 | DI106 | 22.5 | 36 | 8 | 21.5 | 35 | 25 |
| Φ 32 | DI106 | 26.5 | 44 | 8 | 25.5 | 43 | 25 |
| Φ 40 | DI106 | 30 | 51 | 8 | 29 | 50 | 25 |

Cylinder weight (including the mounting nut)

Unit : kg

| Mark Bore | 10Z-6SR | | 10Z-6ASR | | 10Z-6SH | | 10Z-6ASH | |
|--------------|--------------|-------------|--------------|-------------|--------------|-------------|--------------|-------------|
| | Basic weight | Stroke 25mm | Basic weight | Stroke 25mm | Basic weight | Stroke 25mm | Basic weight | Stroke 25mm |
| Φ 16 | 0.089 | 0.019 | 0.086 | 0.019 | 0.090 | 0.09 | 0.087 | 0.019 |
| Φ 20 | 0.154 | 0.029 | 0.141 | 0.029 | 0.156 | 0.029 | 0.142 | 0.029 |
| Φ 25 | 0.199 | 0.043 | 0.185 | 0.043 | 0.201 | 0.043 | 0.187 | 0.043 |
| Φ 32 | 0.339 | 0.062 | 0.313 | 0.062 | 0.342 | 0.062 | 0.316 | 0.062 |
| Φ 40 | 0.515 | 0.098 | 0.482 | 0.098 | 0.520 | 0.098 | 0.487 | 0.098 |

Mounting weight

Unit : kg

| Mark Bore | FA / FB | LB | CU | TA | TB | Y | I | S | F | Nut (Rod) | Nut (Cover) | Sensor switch |
|--------------|---------|-------|-------|-------|-------|-------|-------|-------|-------|--------------|----------------|------------------|
| Φ 16 | 0.026 | 0.079 | 0.031 | 0.079 | 0.079 | 0.018 | 0.09 | 0.030 | 0.024 | 0.002 | 0.017 | 0.045 |
| Φ 20 | 0.049 | 0.173 | 0.064 | 0.173 | 0.173 | 0.046 | 0.044 | 0.053 | 0.061 | 0.005 | 0.011 | 0.045 |
| Φ 25 | 0.049 | 0.173 | 0.064 | 0.173 | 0.173 | 0.088 | 0.080 | 0.080 | 0.113 | 0.008 | 0.011 | 0.045 |
| Φ 32 | 0.099 | 0.218 | 0.089 | 0.218 | 0.218 | 0.088 | 0.080 | 0.080 | 0.113 | 0.008 | 0.030 | 0.045 |
| Φ 40 | 0.132 | 0.315 | 0.090 | 0.315 | 0.315 | 0.151 | 0.157 | 0.175 | 0.245 | 0.016 | 0.038 | 0.045 |



Professional
and
High quality