

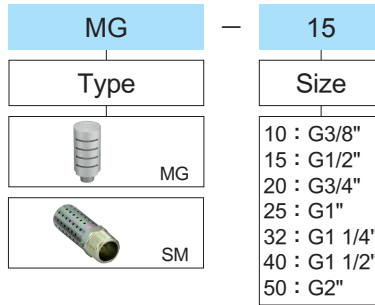

Specifications

Type	MG	SM
Material	Aluminium alloy	steel
Power fluid	Filtered air with or without lubrication	
The range of pressure	0 ~ 21 kgf/cm ²	
Ambient temperature	0 ~ 70 °C (No freezing)	

How to order



Note : Don't suited for MG 10、32

MG Dimensional features

● Size G1/2" ~ G1"

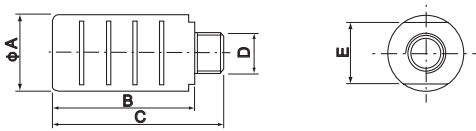

● Size G1 1/2" ~ G2"

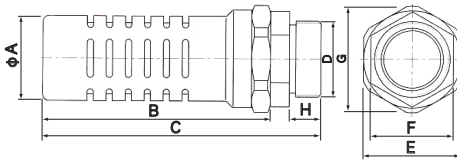

SM Dimensional features

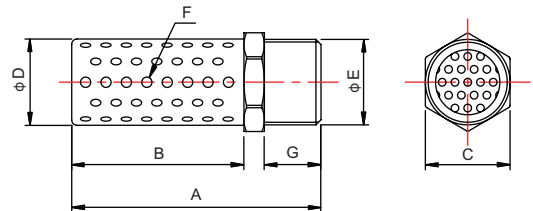

Dimensional table

Type	A	B	C	D	E	F	G	H
MG15	φ 32	70.2	83.5	G1/2"	25.2	—	—	—
MG20	φ 51	96.8	116	G3/4"	41	—	—	—
MG25	φ 51	96.8	116	G1"	41	—	—	—
MG40	φ 67	180	220	G1 1/2"	76.7	65	φ 84	25
MG50	φ 67	180	220	G2"	76.7	65	φ 84	25

Dimensional table

Type	A	B	C	D	E	F	G
SM10	56.5	37.5	17.5	17.5	G3/8"	φ 3.0-28	13
SM15	69.0	45.5	22.2	22.0	G1/2"	φ 3.0-36	17
SM20	82.0	58.0	27.0	26.7	G3/4"	φ 3.0-66	17
SM25	98.5	66.0	33.3	33.3	G1"	φ 3.0-78	22
SM32	114.5	81.0	46.0	42.5	G1 1/4"	φ 4.0-90	23
SM40	124.7	89.3	50.0	50.0	G1 1/2"	φ 4.0-102	23.5
SM50	141.0	102.5	65.0	59.8	G2"	φ 4.0-152	26.3