

Double acting
 - Rod cover / Head cover lock.....







Features

- Hard anodised aluminium cylinder tubes offer a high resistance to corrosion and low internal friction.

Specification

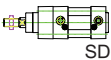
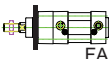
Type	AZK
Bore	Φ 32、40、50、63、80、100
Power fluid	Filtered air with or without lubrication
The range of pressure	1.02 ~ 10.5 kgf/cm ²
The range of temperature	-10 ~ +60 °C (Don't freeze)
Material of cylinder barrel	ALuminium extrusion, Anodised 20 microns

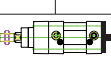
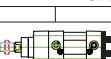
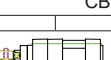
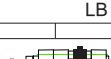
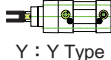
How to order

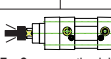
AZK	SD	50	B	50	F	-	Y	-	A	1
Type	Holder	Bore	Cushion	Stroke	End lock type		Accessories		Sensor switch	Quantity
 AZK	 SD  FA  FB  CA  CB  LB  TC	32 : Φ 32 40 : Φ 40 50 : Φ 50 63 : Φ 63 80 : Φ 80 100 : Φ 100	B : with cushion	Please see stroke table	F : Rod cover R : Head cover		 Y : Y Type  S : Oscillating eye  F : Compensating joint		AZRK	1 : 1pc 2 : 2pcs

Stroke table

Bore	Stroke (mm)
Φ 32、40、50、63、80、100	25,50,75,100,125,150,175,200,250,300,350,400,450,500

AZK Double acting - end cover lock / Inside structure

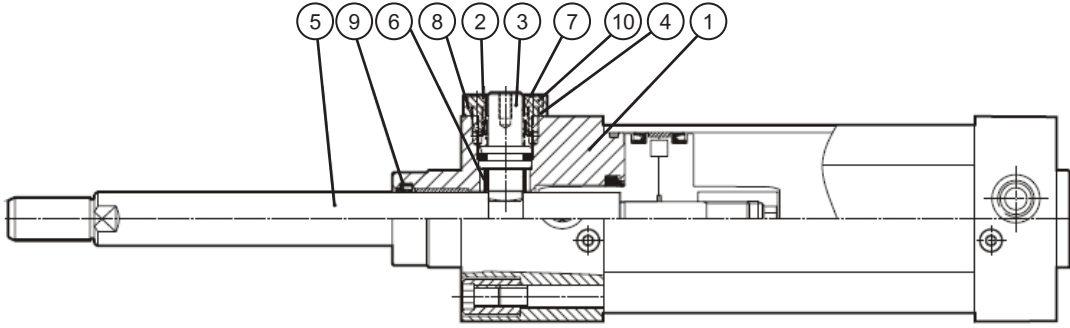

Parts list

No.	Part name	Quantity	No.	Part name	Quantity	Note
1	Rod cover	1	7	Oilless bearing	1	Except left parts, the other parts are the same with AZ.
2	Compression spring	1	8	Piston packing	1	
3	Stopper rod	1	9	Rod packing	1	
4	End cover	1	10	Tie bolt	4	
5	Piston rod	1	11			
6	Oilless bearing	1	12			

AZK Double acting - head cover lock / Inside structure

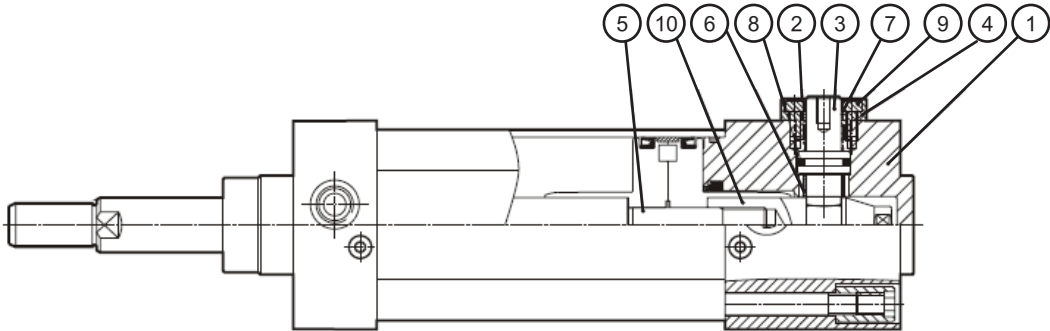

Parts list

No.	Part name	Quantity	No.	Part name	Quantity	Note
1	Head cover	1	7	Oilless bearing	1	Except left parts, the other parts are the same with AZ.
2	Compression spring	1	8	Piston packing	1	
3	Stopper rod	1	9	Tie bolt	4	
4	End cover	1	10	Piston nut	1	
5	Piston rod	1	11			
6	Oilless bearing	1	12			

AZK Double acting - end cover lock / Dimensional features

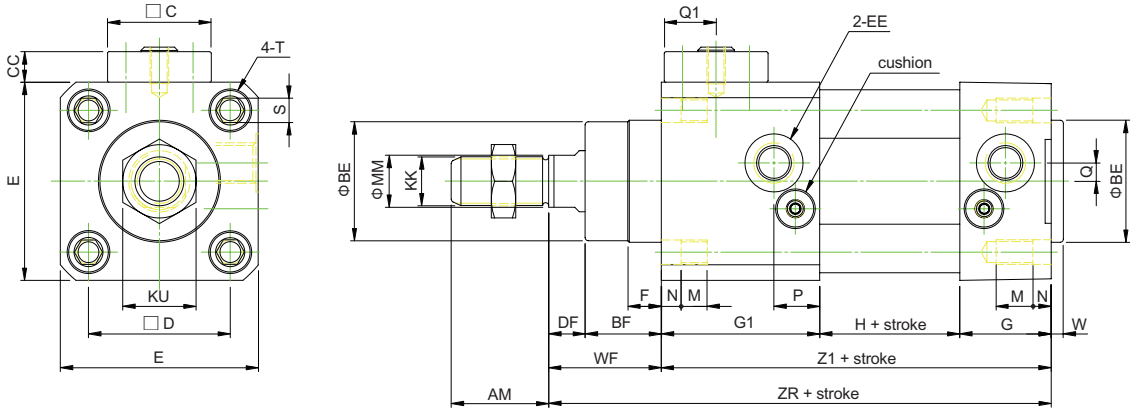

AZK Double acting - head cover lock / Dimensional features

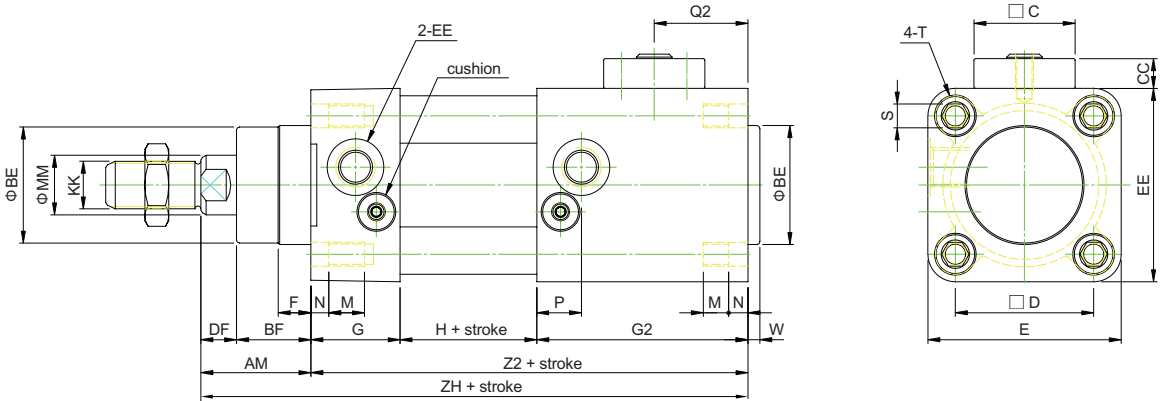

Dimensional Table

Mark Bore	AM	BE	BF	C	CC	D	DF	E	EE	F	G	G1	G2	H	W	KK
Φ32	22	30	16	21	10	32.5	10	47	G 1/8	7	26	40	47	42	4	M10x1.25
Φ40	24	35	20	30	10	38	10	53	G 1/4	9	30	48	56	45	5	M12x1.25
Φ50	32	40	25	34	10	46.5	12	65	G 1/4	11	30	52	71	46	5	M16x1.5
Φ63	32	45	25	34	10	56.5	12	75	G 3/8	13	32	52	70	57	4	M16x1.5
Φ80	40	45	32	39	10	72	14	95	G 3/8	15	38	66	80	52	6	M20x1.5
Φ100	40	55	35	39	10	89	16	115	G 1/2	15	40	70	80	58	6	M20x1.5

Mark Bore	KU	M	MM	N	P	Q	Q1	Q2	S	T	WF	Z1	Z2	ZR	ZH
Φ32	10	9	12	6	13	4.5	11.5	17.5	6	M6	26	108	115	134	141
Φ40	14	9	16	6	15	5	16.5	24	6	M6	30	123	131	153	161
Φ50	17	12	20	6	15	6	18	31.5	8	M8	37	128	147	165	184
Φ63	17	12	20	6	16	8	18	35.5	8	M8	37	141	159	178	196
Φ80	22	16	25	6	19	9	20.5	35	10	M10	46	156	170	202	216
Φ100	22	16	25	6	20	7	20.5	34	10	M10	51	168	178	219	229

FA Double acting - end cover lock / Accessories

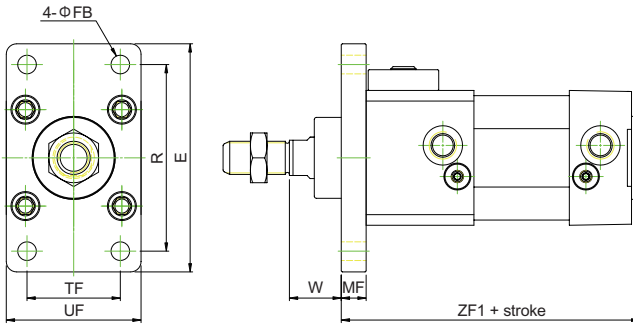

FA Double acting - head cover / Accessories

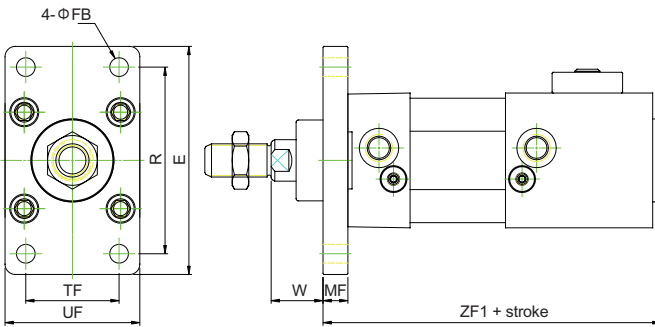

FB Double acting - end cover lock / Accessories

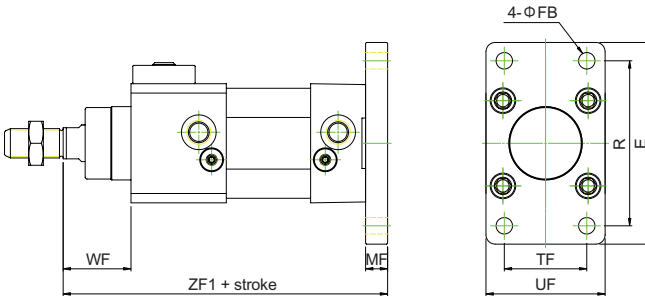

FB Double acting - head cover lock / Accessories

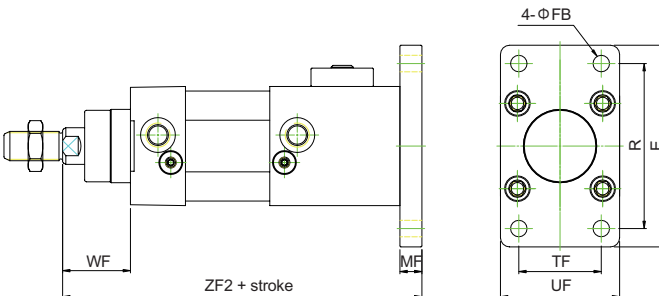

Dimensional Table

Mark Bore	E	FB	MF	R	TF	UF	W	ZF1	ZF2
Φ32	79	7	10	64	32	50	16	122	129
Φ40	90	9	10	72	36	55	20	138	146
Φ50	110	9	12	90	45	65	25	145	164
Φ63	120	9	12	100	50	75	25	157	175
Φ80	153	12	16	126	63	95	30	178	192
Φ100	178	14	16	150	75	115	35	190	200

Dimensional Table

Mark Bore	E	FB	MF	R	TF	UF	WF	ZF1	ZF2
Φ32	79	7	10	64	32	50	26	144	151
Φ40	90	9	10	72	36	55	30	163	171
Φ50	110	9	12	90	45	65	37	177	196
Φ63	120	9	12	100	50	75	37	190	208
Φ80	153	12	16	126	63	95	46	218	232
Φ100	178	14	16	150	75	115	51	235	245

TC Double acting - end cover lock / Accessories

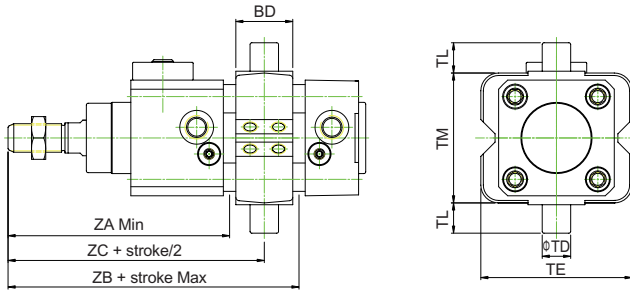

TC Double acting - head cover lock / Accessories

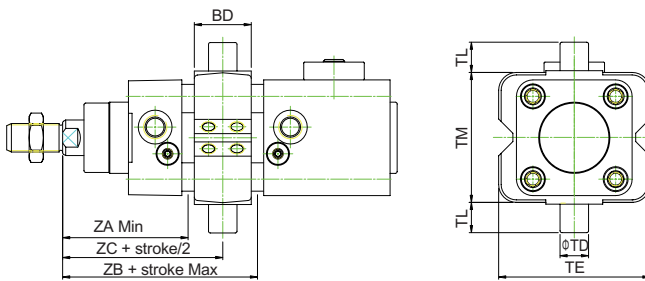

Dimensional Talbe

Mark Bore	BD	TD	TE	TL	TM	ZA	ZB	ZC
Φ32	22	12	58	12	50	80	94	87
Φ40	28	16	70	16	63	95	106	100.5
Φ50	32	16	85	16	75	108	116	112
Φ63	35	20	100	20	90	110	125.5	117.5
Φ80	40	20	120	20	110	135	141	138
Φ100	45	25	145	25	132	147	153.5	150

Dimensional Talbe

Mark Bore	BD	TD	TE	TL	TM	ZA	ZB	ZC
Φ32	22	12	58	12	50	73	73	73
Φ40	28	16	70	16	63	77	88	82.5
Φ50	32	16	85	16	75	86	94	90
Φ63	35	20	100	20	90	89.5	105.5	97.5
Φ80	40	20	120	20	110	107	113	110
Φ100	45	25	145	25	132	116.5	123.5	120

CA Double acting - end cover lock / Accessories

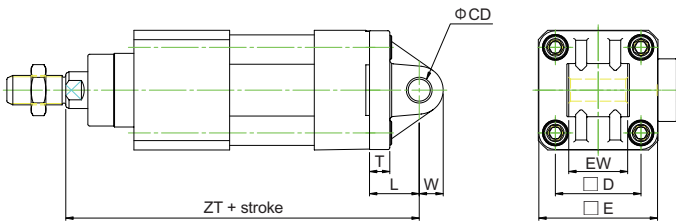

CA Double acting - head cover lock / Accessories

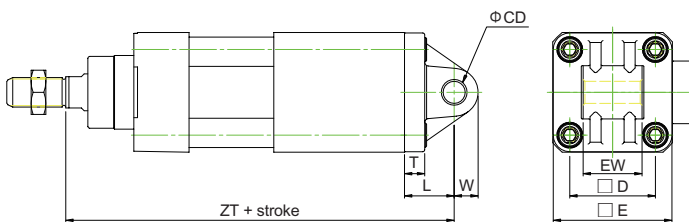

Dimensional Talbe

Mark Bore	CD	D	E	EW	L	T	W	ZT
Φ32	10	32.5	47	26	22	10	10.5	156
Φ40	12	38	53	28	25	10	13	178
Φ50	12	46.5	65	32	27	12	13	192
Φ63	16	56.5	75	40	32	12	17	210
Φ80	16	72	95	50	36	16	17	238
Φ100	20	89	115	60	41	16	21	260

Dimensional Talbe

Mark Bore	CD	D	E	EW	L	T	W	ZT
Φ32	10	32.5	47	26	22	10	10.5	163
Φ40	12	38	53	28	25	10	13	186
Φ50	12	46.5	65	32	27	12	13	211
Φ63	16	56.5	75	40	32	12	17	228
Φ80	16	72	95	50	36	16	17	252
Φ100	20	89	115	60	41	16	21	270

CB Double acting - end cover lock / Accessories

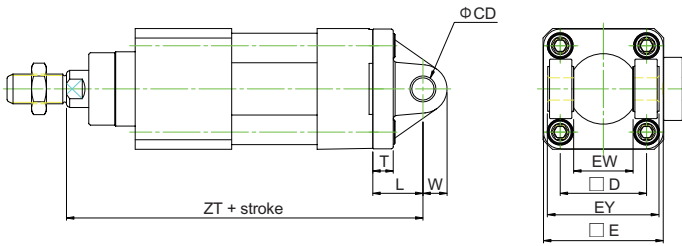

CB Double acting - head cover lock / Accessories

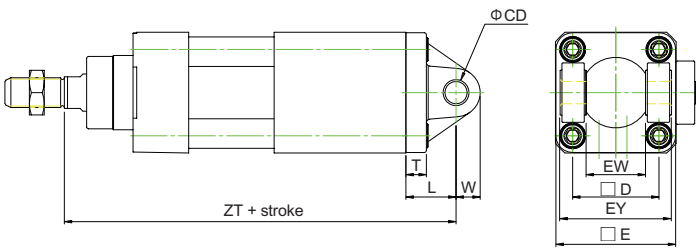

Dimensional Talbe

Mark Bore	CD	D	E	EW	EY	L	T	W	ZT
Φ32	10	32.5	47	26	45	22	10	10.5	156
Φ40	12	38	53	28	52	25	10	11	178
Φ50	12	46.5	65	32	60	27	12	12	192
Φ63	16	56.5	75	40	70	32	12	15	210
Φ80	16	72	95	50	90	36	16	17	238
Φ100	20	89	115	60	110	41	16	21	260

Dimensional Talbe

Mark Bore	CD	D	E	EW	EY	L	T	W	ZT
Φ32	10	32.5	47	26	45	22	10	10.5	163
Φ40	12	38	53	28	52	25	10	11	186
Φ50	12	46.5	65	32	60	27	12	12	211
Φ63	16	56.5	75	40	70	32	12	15	228
Φ80	16	72	95	50	90	36	16	17	252
Φ100	20	89	115	60	110	41	16	21	270

LB Double acting - end cover lock / Accessories

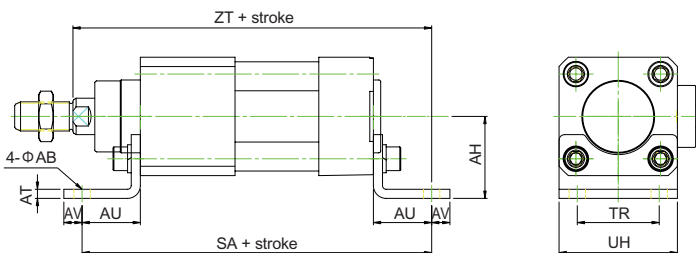

LB Double acting - head cover lock / Accessories

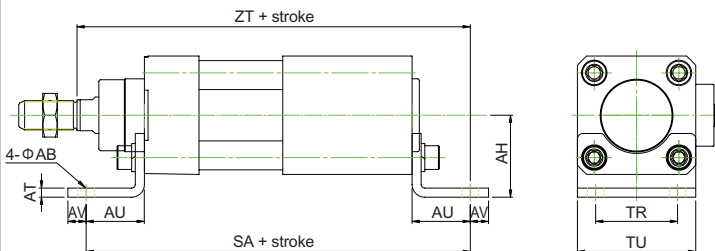

Dimensional Talbe

Mark Bore	AB	AH	AT	AU	AV	SA	TR	UH	ZT
Φ32	7	32	5	24	8	156	32	47	158
Φ40	9	36	5	28	10	179	36	53	181
Φ50	9	45	5	32	10	192	45	65	197
Φ63	9	50	5	32	10	205	50	75	210
Φ80	12	63	6	41	13	238	63	95	243
Φ100	14	71	6	41	15	250	75	115	260

Dimensional Talbe

Mark Bore	AB	AH	AT	AU	AV	SA	TR	UH	ZT
Φ32	7	32	5	24	8	163	32	47	165
Φ40	9	36	5	28	10	187	36	53	189
Φ50	9	45	5	32	10	211	45	65	216
Φ63	9	50	5	32	10	223	50	75	228
Φ80	12	63	6	41	13	252	63	95	257
Φ100	14	71	6	41	15	260	75	115	270

AZ

Y Rod clevis / Accessories

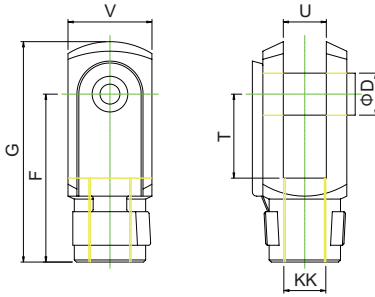

Dimensional Table

Mark Bore	D	F	G	KK	T	U	V
$\Phi 32$	10	40	52	M10x1.25	20	10	20
$\Phi 40$	12	48	62	M12x1.25	24	12	24
$\Phi 50 \text{ \textasciitilde } 63$	16	64	83	M16x1.5	32	16	32
$\Phi 80 \text{ \textasciitilde } 100$	20	80	105	M20x1.5	40	20	40

S Oscillating eye / Accessories

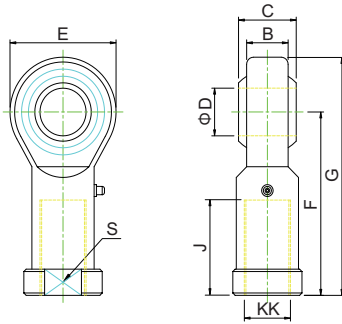

Dimensional Table

Mark Bore	B	C	D	E	F	G	J	KK	S
$\Phi 32$	10.5	14	10	28	43	57	20	M10x1.25	17
$\Phi 40$	12	16	12	30	50	65	24	M12x1.25	19
$\Phi 50 \text{ \textasciitilde } 63$	15	21	16	38	64	80	33	M16x1.5	22
$\Phi 80 \text{ \textasciitilde } 100$	18	25	20	46	77	100	40	M20x1.5	30

F Compensating joint / Accessories

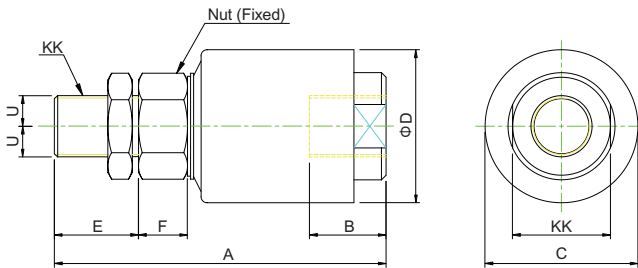

Dimensional Table

Mark Bore	A	B	C	D	E	F	KK	U
$\Phi 32$	54	13	24	25.5	12.5	8	M10x1.25	1
$\Phi 40$	71	17	29	31	16	10	M12x1.25	1.15
$\Phi 50 \text{ \textasciitilde } 63$	88	21	27	38	24	13	M16x1.5	1.65
$\Phi 80 \text{ \textasciitilde } 100$	105	25	32	50	27.5	16	M20x1.5	2.15



Professional
and
High quality