

Norminal Size 7 and 12

Indirectly solenoid pilot actuated
 Spool with pressure energized soft seals
 Port size G1/4, up G1/2
 Operating pressure : 2.5 to 10 bar
 (see Parameters)



Features

- Integrated sound absorption eliminating objectionable air noise
- Straight thru flow paths assuring high flow rates and fast response time
- Simple, compact yet most efficient design thanks to T-ring system
- Easy to service
- Uncomplicated and fast replacement of solenoids
- Compact design
- Standard manual override
- No overlap

Description (Standard type)

- Solenoid valve for filtered, lubricator* or non-lubricated air
- Flow direction : Fixed
- Temperature range : -10 °C ~ +60 °C
- Material - Body : Aluminum
- Material - Seat Seal : NBR

Parameters

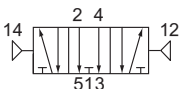
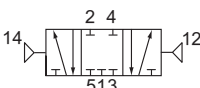
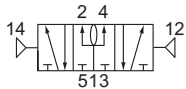
Symbol	Cat. No. Valve	Nominal size (ND)	Port size (G)	Operating pressure[bar]		Flow rate QN [l/min]	Switching time* approx.[ms]	Weight [kg]	Solenoid and Connector
				min.	max.				
	2523200	7	G1/4	3	10	900	30	1.0	—
	2523220	7	G3/8	3	10	900	30	1.0	
	2523700	12	G1/2	2.5	10	2000	55	1.6	
	2523300	7	G1/4	3	10	900	30	1.0	
	2523320	7	G3/8	3	10	900	30	1.0	
	2523800	12	G1/2	2.5	10	2000	55	1.6	
	2523400	7	G1/4	3	10	900	30	1.0	
	2523420	7	G3/8	3	10	900	30	1.0	

* Oil recommendation : Shell Hydrol DO 32, Shell Febis K32 (as of July 1992) or compatible oils with DVI values < 8 (DIN53521) and ISO viscosity class 32-46 (DIN51519)

How to Order

example : 2523200 X 5
Valve Quantity

Dimensional drawings

Cat. No. : 2523200 / 2523300 / 2523400

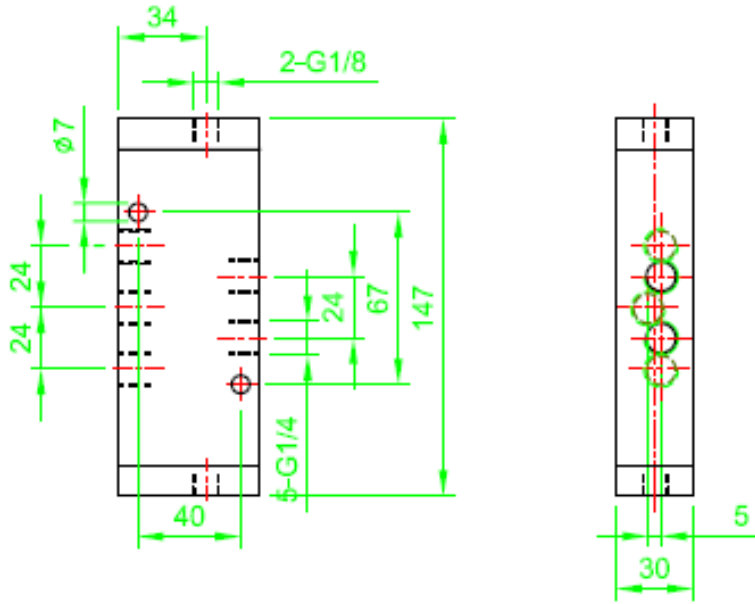

Cat. No. : 2523220 / 2523320 / 2523420

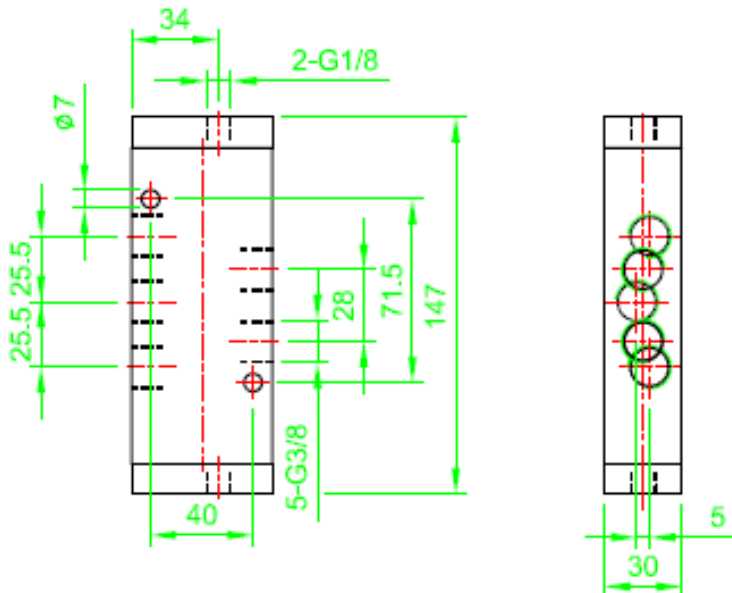

Dimensional drawings

Cat. No. : 2523700 / 2523800

