

Solenoid Pilot operated spool valve  
 Port size G1/8, manifold system G1/4  
 Operating pressure : 1.5 to 7 bar

## Features



- Straight manual override with and without detent
- Mounting position optional
- Small size, high flow rate, easy installation
- Exhaust air attenuated
- Common exhaust
- Connector protection class to IP65 En60529
- Low power consumption



## Description (Standard type)

- Solenoid valve for filtered, lubricator\* or non-lubricated air
- Flow direction : Fixed
- Temperature range : -10 °C ~ +60 °C
- Material - Body : Aluminum
- Material - Seat Seal : NBR

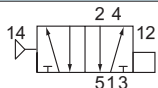
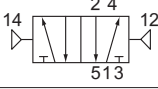
## Parameters

| Symbol   | Cat. No.<br>Valve | Port size<br>(G) | Operating pressure[bar] |      | Flow rate<br>QN [l/min] | Switching time<br>approx.[ms] |     | Weight<br>[kg] | Solenoid<br>and<br>Connector |
|--|-------------------|------------------|-------------------------|------|-------------------------|-------------------------------|-----|----------------|------------------------------|
|  |                   |                  | min.                    | max. |                         | ON                            | OFF |                |                              |
|   | 2521000           | G1/8             | 1.5                     | 7    | 650                     | 10                            | 10  | 0.1            | -                            |
|  | 2521100           | G1/8             | 1.5                     | 7    | 650                     | 10                            | 10  | 0.1            |                              |
|  | 2521551           | G1/4             | 1                       | 7    | 1000                    | 20                            | 20  | 0.25           |                              |
|  | 2521552           | G1/4             | 1                       | 7    | 1000                    | 20                            | 20  | 0.30           |                              |

\* Oil recommendation : Shell Hydrol DO 32, Shell Febis K32 (as of July 1992) or compatible oils with DVI values < 8 (DIN53521) and ISO viscosity class 32-46 (DIN51519)

## How to Order

example : 2521000 X 5  
Valve Quantity

**Dimensional drawings**

Cat. No. : 2521000

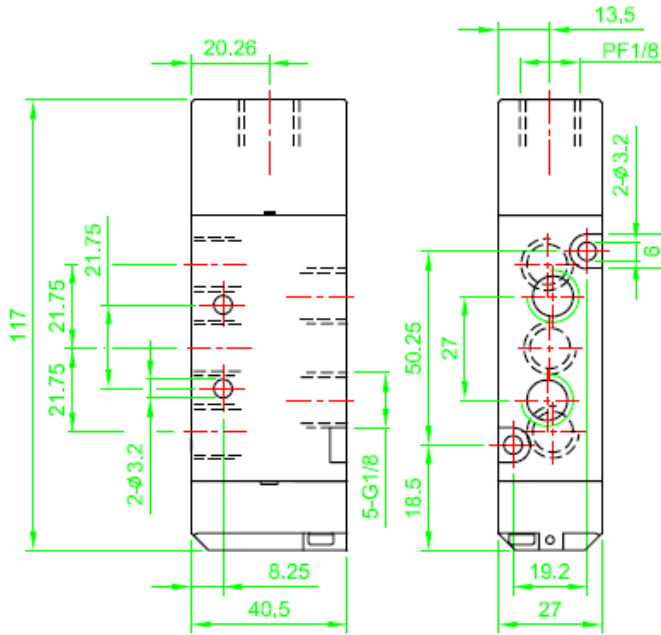

Cat. No. : 2521100

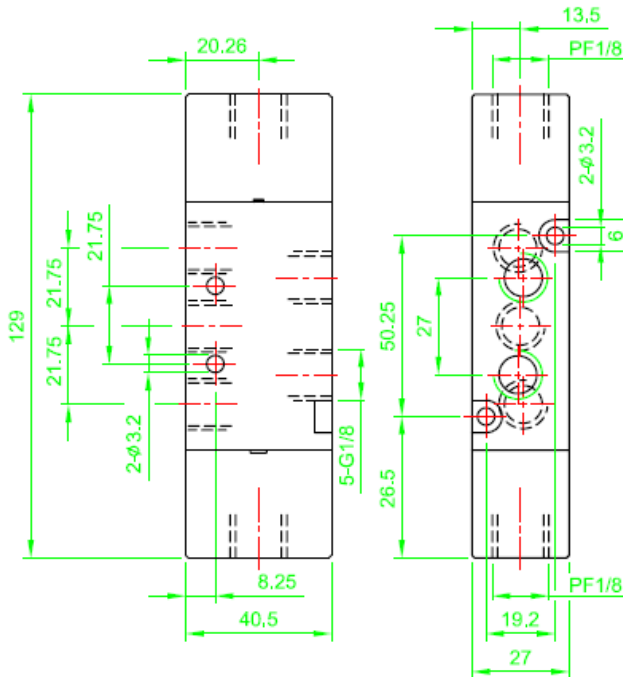

Dimensional drawings

Cat. No. : 2521551

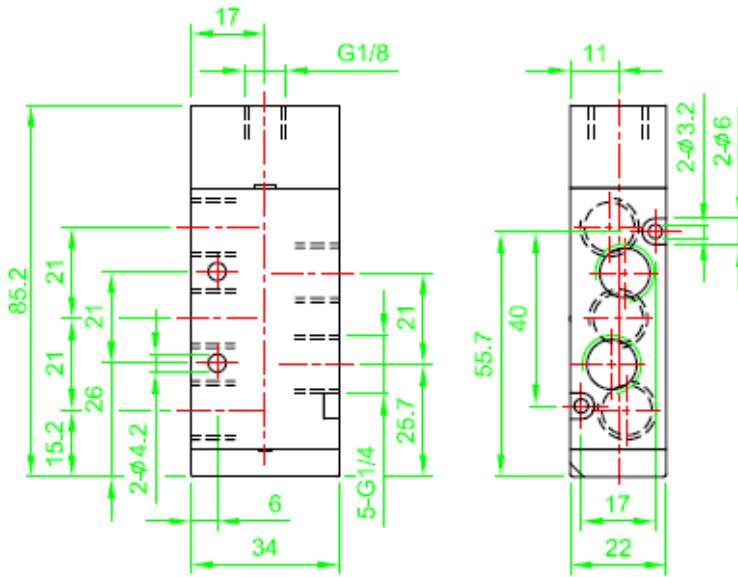

Cat. No. : 2521552

