

## Normal Size 4 and 7

Solenoid pilot actuated  
 Spool with pressure energized soft seals  
 Port size G1/8, manifold system G1/4  
 Operating pressure : 1 to 10 bar



## Features

- Straight manual override with and without detent
- Mounting position optional
- Small size, high flow rate, easy installation
- Exhaust air attenuated
- Common exhaust
- Connector interface to DIN 43650, from B and industrial form
- Low power consumption

## Description (Standard type)

- Solenoid valve for filtered, lubricator\* or non-lubricated air
- Flow direction : Fixed
- Temperature range : -10 °C ~ +60 °C
- Material - Body : Aluminum
- Material - Seat Seal : NBR

## Parameters

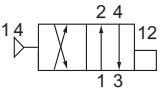
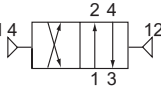
| Symbol   | Cat. No.<br>Valve | Nominal size<br>(ND) | Port size<br>(G) | Operating pressure[bar] |      | Flow rate<br>QN [l/min] | Switching time*<br>approx.[ms] |     | Weight<br>[kg] | Solenoid<br>and<br>Connector |
|--|-------------------|----------------------|------------------|-------------------------|------|-------------------------|--------------------------------|-----|----------------|------------------------------|
|  |                   |                      |                  | min.                    | max. |                         | ON                             | OFF |                |                              |
|  | 2522000           | 4                    | G1/8             | 1                       | 10   | 700                     | 20                             | 20  | 0.3            | —                            |
|  | 2522020           | 4                    | G1/4             | 1                       | 10   | 700                     | 20                             | 20  | 0.3            |                              |
|  | 2522200           | 7                    | G1/4             | 1                       | 10   | 1900                    | 40                             | 27  | 0.39           |                              |
|  | 2522100           | 4                    | G1/8             | 1                       | 10   | 700                     | 11                             | 12  | 0.4            |                              |
|  | 2522120           | 4                    | G1/4             | 1                       | 10   | 700                     | 11                             | 12  | 0.4            |                              |
|  | 2522300           | 7                    | G1/4             | 1                       | 10   | 1900                    | 24                             | 27  | 0.62           |                              |

\* Oil recommendation : Shell Hydrol DO 32, Shell Febis K32 (as of July 1992) or compatible oils with DVI values < 8 (DIN53521) and ISO viscosity class 32-46 (DIN51519)

\* at 6 bar to VDI3290 with DC solenoid

## How to Order

example : **2522000** X **5**  
 Valve                      Quantity



## Dimensional drawings

Cat. No. : 2522200

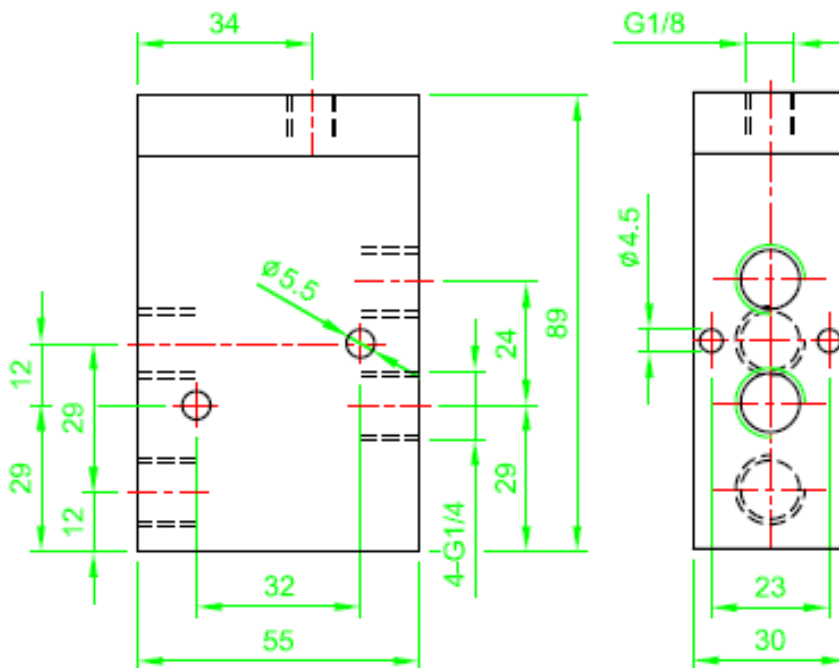

Cat. No. : 2522100

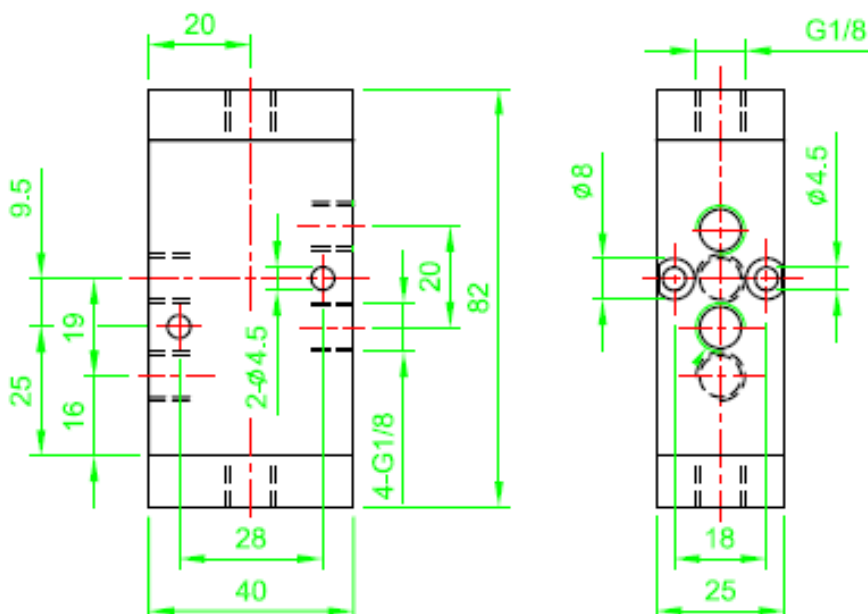

**Dimensional drawings**

Cat. No. : 2522120

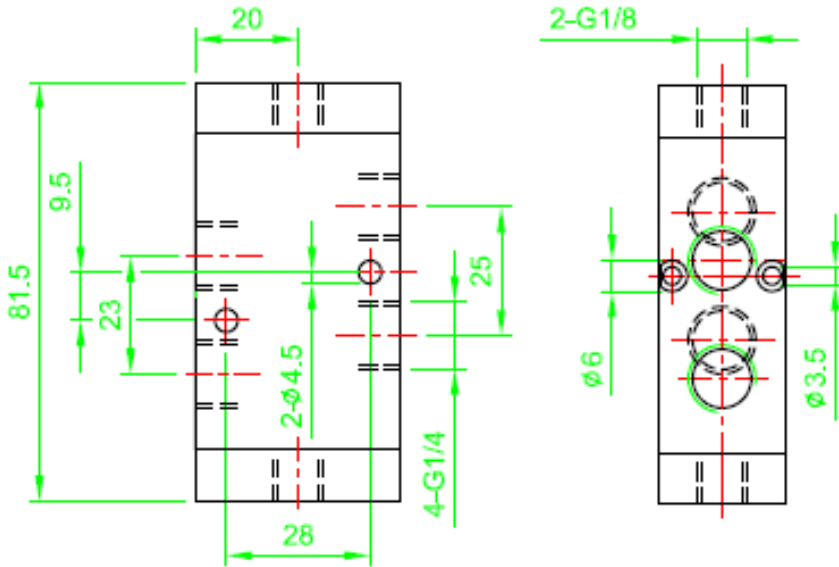

Cat. No. : 2522300

