

## Normal Size 4 and 7

Solenoid pilot actuated  
 Spool with pressure energized soft seals  
 Port size G1/8, manifold system G1/4  
 Operating pressure : 1 to 10 bar



## Features

- Straight manual override with and without detent
- Mounting position optional
- Small size, high flow rate, easy installation
- Exhaust air attenuated
- Common exhaust
- Connector interface to DIN 43650, from B and industrial form
- Low power consumption

## Description (Standard type)

- Solenoid valve for filtered, lubricator\* or non-lubricated air
- Flow direction : Fixed
- Temperature range : -10 °C ~ +60 °C
- Material - Body : Aluminum
- Material - Seat Seal : NBR

## Parameters

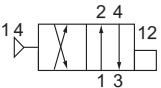
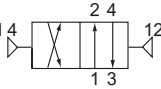
Symbol	Cat. No. Valve	Nominal size (ND)	Port size (G)	Operating pressure[bar]		Flow rate QN [l/min]	Switching time* approx.[ms]		Weight [kg]	Solenoid and Connector
				min.	max.		ON	OFF		
	2522000	4	G1/8	1	10	700	20	20	0.3	—
	2522020	4	G1/4	1	10	700	20	20	0.3	
	2522200	7	G1/4	1	10	1900	40	27	0.39	
	2522100	4	G1/8	1	10	700	11	12	0.4	
	2522120	4	G1/4	1	10	700	11	12	0.4	
	2522300	7	G1/4	1	10	1900	24	27	0.62	

\* Oil recommendation : Shell Hydrol DO 32, Shell Febis K32 (as of July 1992) or compatible oils with DVI values < 8 (DIN53521) and ISO viscosity class 32-46 (DIN51519)

\* at 6 bar to VDI3290 with DC solenoid

## How to Order

example : 2522000 X 5  
 Valve                      Quantity

**Dimensional drawings**

Cat. No. : 2522000

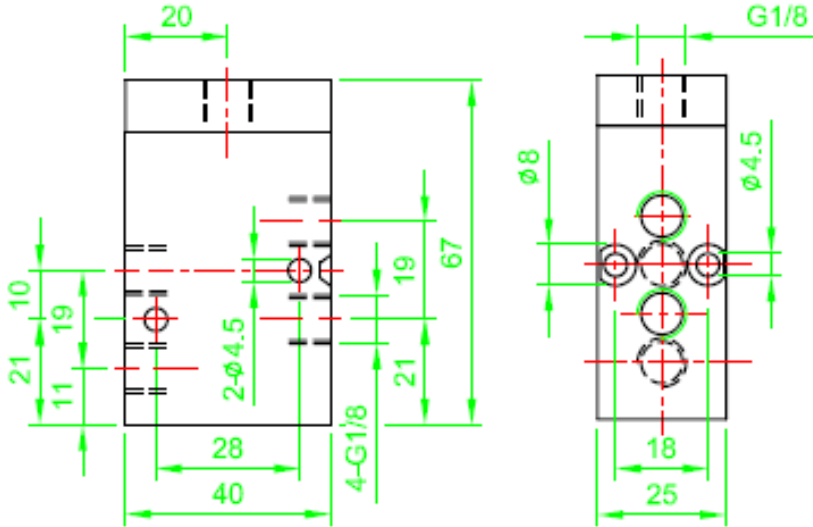

Cat. No. : 2522020

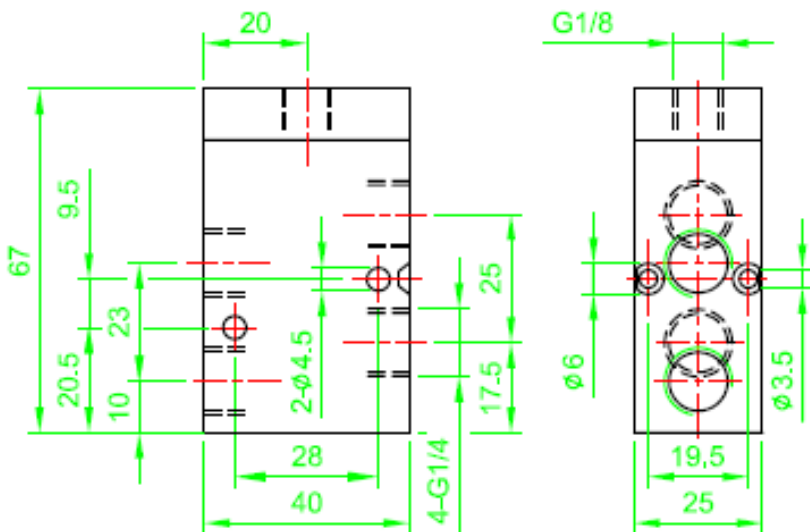

4/2

## Dimensional drawings

Cat. No. : 2522200

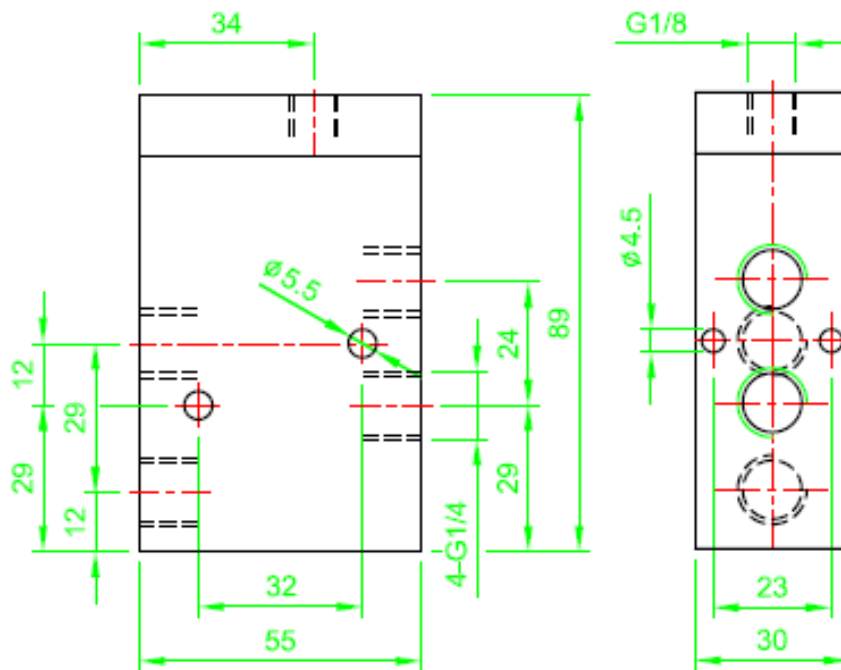

Cat. No. : 2522100

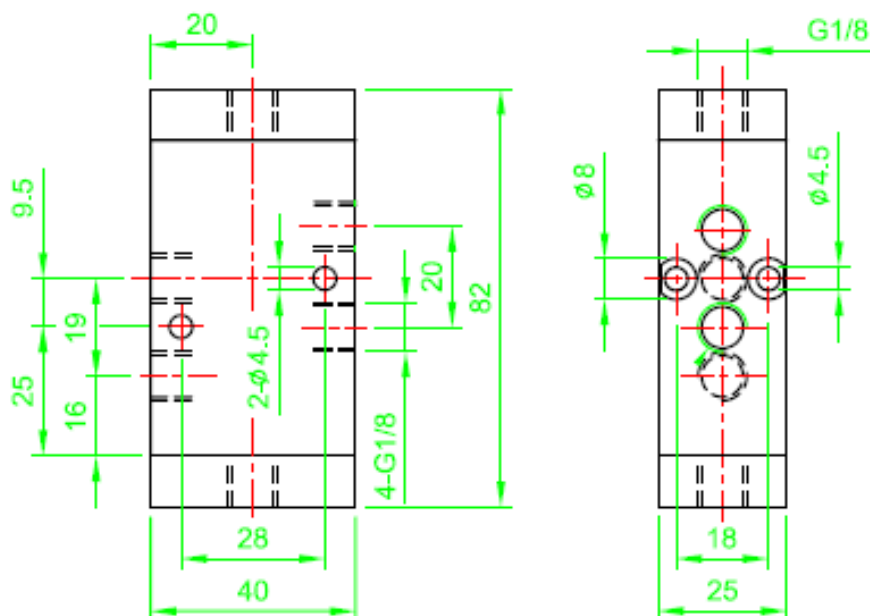

**Dimensional drawings**

Cat. No. : 2522120

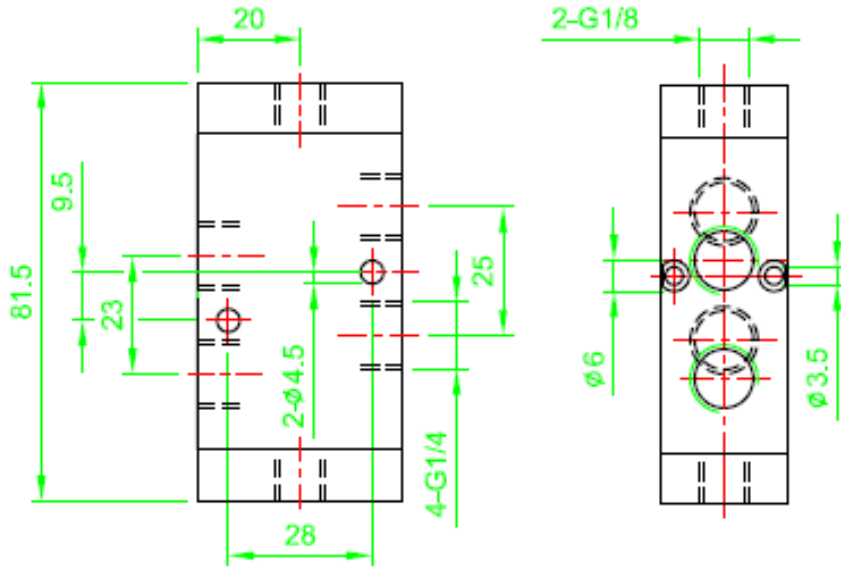

Cat. No. : 2522300

