

## Normal Size 5, 7, 12

Solenoid pilot actuated  
 Spool with pressure energized soft seals  
 Port size G1/8, G1/4, G1/2  
 Operating pressure : 10 bar Max.



## Features

- Straight thru flow paths assuring high flow rates and fast response time
- Simple, compact, easy to service design
- Interchangeable solenoid system
- Delrin spool equipped with Polyurethane
- T-ring giving rugged resistance to wear along with low friction, thus resulting in savings on maintenance
- Pressure molded epoxy encapsulated coil, easily interchangeable
- Sintered bronze muffler on pilot exhaust protects against aerosol and eliminates objectionable air noise
- Manual override

## Description (Standard type)

- Solenoid valve for filtered, lubricator\* or non-lubricated air
- Flow direction : Fixed
- Temperature range : -10 °C ~ +60 °C
- Material - Body : Aluminum
- Material - Seat Seal : NBR

## Parameters

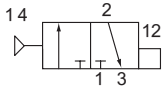
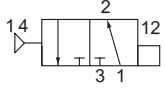
Symbol	Cat. No. Valve	Nominal size (ND)	Port size (G)	Operating pressure[bar]		Flow rate QN [l/min]	Switching time approx.[ms]	Weight [kg]	Solenoid and Connector
				min.	max.				
	8510650	5	G1/8	1	10	700	20	0.30	-
	8510750	7	G1/4	1	10	1200	20	0.40	
	8510850	12	G1/2	1	10	3000	25	0.70	
	8512650	5	G1/8	1	10	700	20	0.30	
	8512750	7	G1/4	1	10	1200	20	0.40	
	8512850	12	G1/2	1	10	3000	25	0.70	

\* The valves are suitable for dry running. Shell Hydrol DO32, Shell Voltol 64 Esso Febis K32 or oil of equal quality are recommended for the system lubrication

## How to Order

example : 8510750 X 5  
Valve Quantity

**Dimensional drawings**

Cat. No. : 8510650

Cat. No. : 8512650

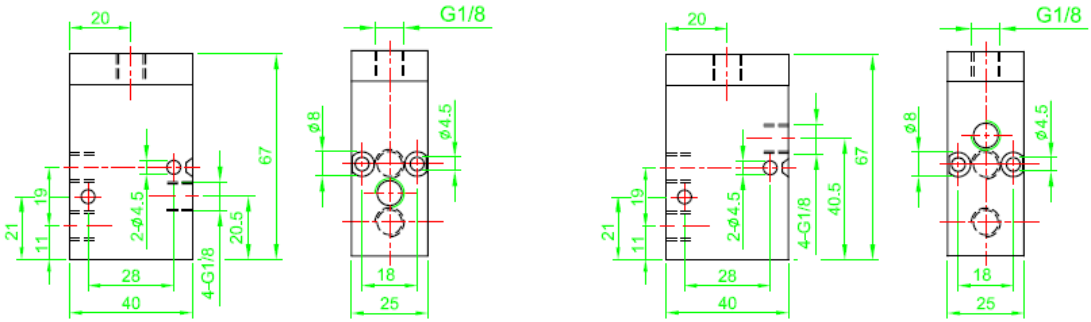

Cat. No. : 8510750 / 8512750

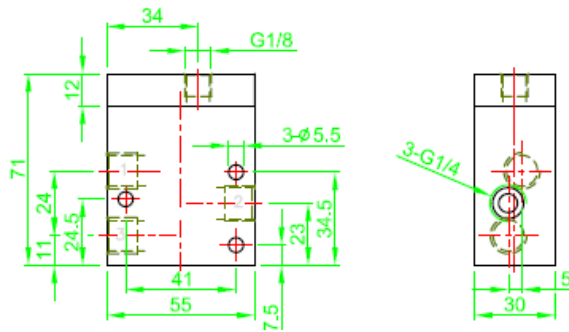

Cat. No. : 8510850 / 8512850

